

ALTERNATIVE 1 - NO BUILD

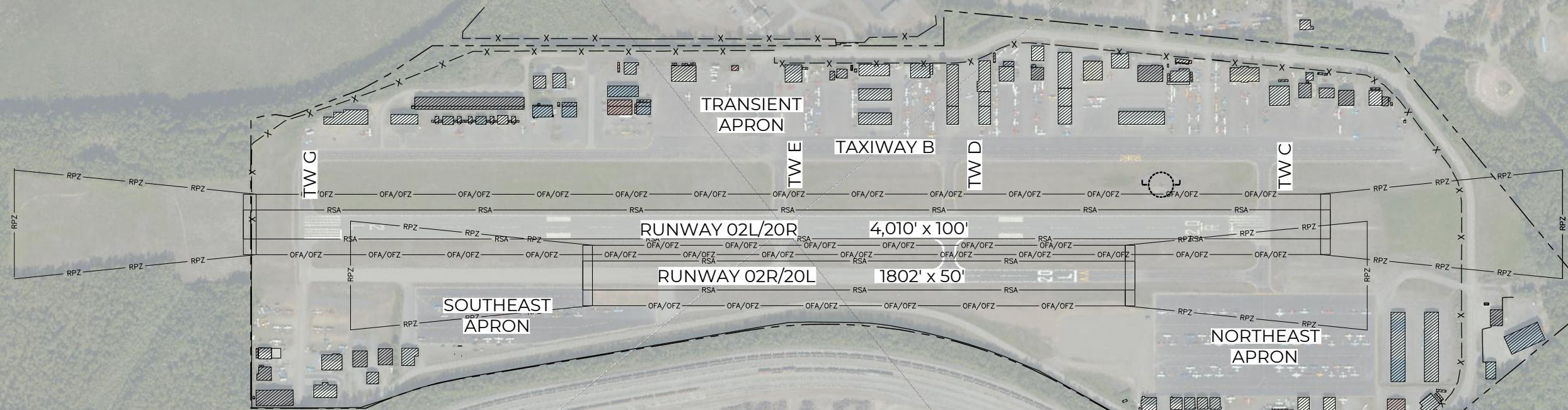

LEGEND

- RSA RUNWAY SAFETY AREA
- OFA/OFZ OBJECT FREE AREA/ZONE
- RPZ RUNWAY PROTECTION ZONE

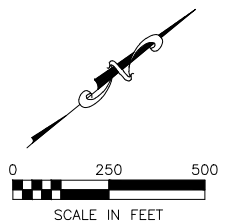

BIRCHWOOD AIRPORT MASTER PLAN EXHIBIT - ALTERNATIVE 1 DEPARTMENT OF TRANSPORTATION AND PUBLIC FACILITIES/CR BIRCHWOOD, ALASKA		
DATE: 11-7-2022	DRAWN BY: TA/TC	SHEET: 1
SCALE: 1" = 250'	CHECKED BY: MS	JOB NO.: 20-014

ALTERNATIVE 2

- | | | |
|--|---|--|
| 1 ACQUIRE AIRPORT PROPERTY (APPROX. 61 ACRES) | 9 RECONSTRUCT EXISTING TAXIWAY G | 17 DEVELOP NEW VEHICLE PARKING AREA WITH PORTABLE PUBLIC RESTROOM FACILITIES |
| 2 RECONSTRUCT RUNWAY 02L/20R | 10 CONSTRUCT NEW APRON (122 TIE-DOWNS) | 18 CONSTRUCT ACCESS ROADS |
| 3 REMOVE TAXIWAY A SEGMENTS | 11 INSTALL ELECTRICAL OUTLETS AT NEW TIE-DOWN SPACES | 19 REMOVE EXISTING FENCING |
| 4 CONSTRUCT TAXIWAY A EXTENSION | 12 NEW HANGAR LEASE LOT AREA | 20 CONSTRUCT NEW PERIMETER FENCING |
| 5 ACQUIRE AIRPORT PROPERTY (APPROX. 1.2 ACRES) | 13 NEW T-HANGAR LEASE LOT AREA | 21 CONSTRUCT NEW SEPTIC SYSTEM AT PILOT BRIEFING SHELTER |
| 6 RECONSTRUCT EXISTING TAXIWAY D | 14 CONSTRUCT NEW TRANSIENT AIRCRAFT PARKING APRON (10 TIE-DOWNS) | 22 CONSTRUCT NEW PAPI |
| 7 REMOVE EXISTING TAXIWAY E | 15 EXPAND NORTHEAST APRON (25 TIE-DOWNS) | |
| 8 CONSTRUCT NEW TAXIWAY F | 16 CONSTRUCT SUMMER AIRCRAFT TIE-DOWN AREA/WINTER SNOW STORAGE AREA (4 TIE-DOWNS) | |

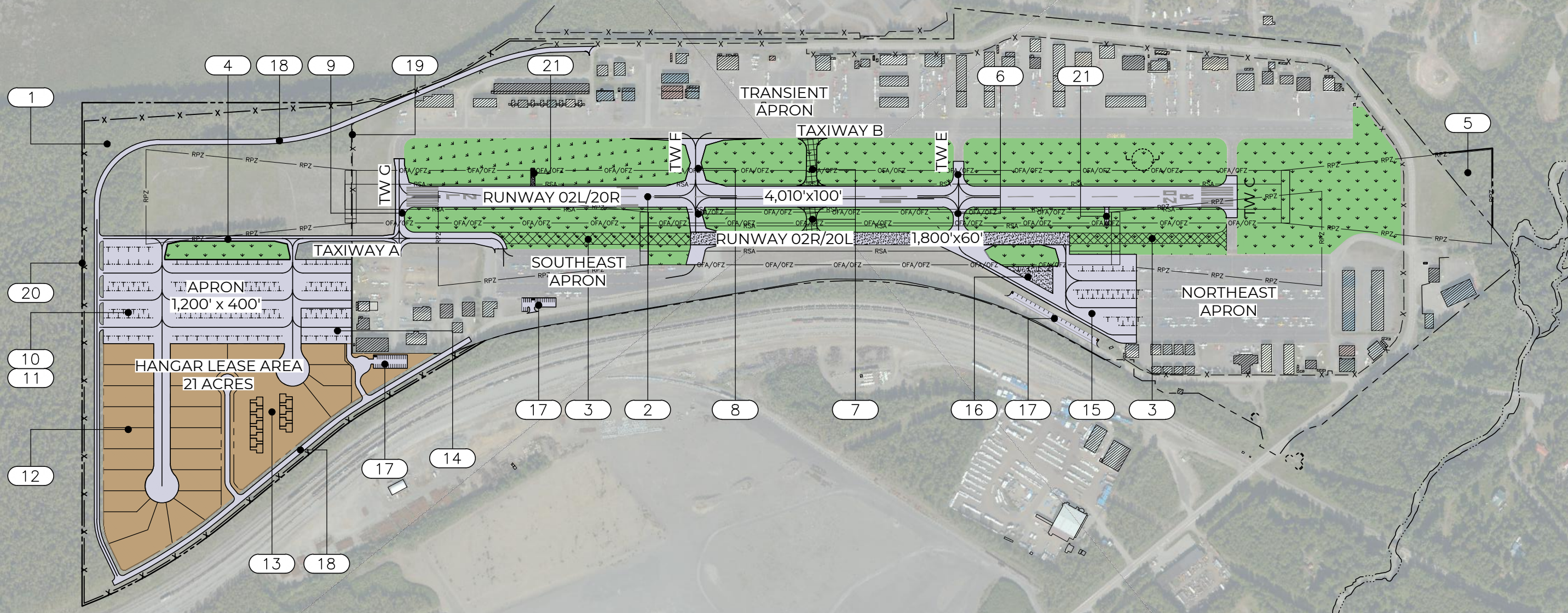

LEGEND

- | | |
|-------------------------------------|------------------------------------|
| HANGAR DEVELOPMENT AREAS | PROPOSED AIRPORT PROPERTY BOUNDARY |
| NEW GRASS AREA | NEW FENCE |
| NEW PAVEMENT | RUNWAY SAFETY AREA |
| NEW GRAVEL SURFACE | OBJECT FREE AREA/ZONE |
| PARKING & PORTABLE PUBLIC RESTROOMS | RUNWAY PROTECTION ZONE |
| AIRCRAFT TIE-DOWN | |

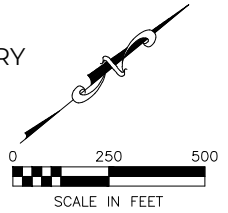

BIRCHWOOD AIRPORT MASTER PLAN EXHIBIT - ALTERNATIVE 2 DEPARTMENT OF TRANSPORTATION AND PUBLIC FACILITIES/CR BIRCHWOOD, ALASKA		
DATE: 11-7-2022	DRAWN BY: TA/TC	SHEET: 2
SCALE: 1" = 250'	CHECKED BY: MS	JOB NO.: 20-014

ALTERNATIVE 3

- | | | | | | |
|---|--|----|---|----|--|
| 1 | ACQUIRE AIRPORT PROPERTY (APPROX. 61 ACRES) | 9 | EXTEND EXISTING TAXIWAY E | 18 | CONSTRUCT SUMMER AIRCRAFT TIE-DOWN AREA/WINTER SNOW STORAGE AREA (5 TIE-DOWNS) |
| 2 | RECONSTRUCT RUNWAY 02L/20R | 10 | CONSTRUCT NEW TAXIWAY F | 19 | DEVELOP NEW VEHICLE PARKING AREA WITH PORTABLE PUBLIC RESTROOM FACILITIES |
| 3 | CONSTRUCT NEW "SHOULDER" GRAVEL/SKI RUNWAY 02R/20L | 11 | RECONSTRUCT EXISTING TAXIWAY G | 20 | CONSTRUCT ACCESS ROADS |
| 4 | REMOVE EXISTING RUNWAY 02R/20L | 12 | CONSTRUCT NEW APRON (104 TIE-DOWNS) | 21 | REMOVE EXISTING FENCE |
| 5 | RELOCATE AND RECONSTRUCT TAXIWAY A TO PROVIDE REQUIRED RUNWAY SEPARATION | 13 | INSTALL ELECTRICAL OUTLETS AT TIE-DOWN SPACES | 22 | CONSTRUCT NEW PERIMETER FENCING |
| 6 | CONSTRUCT TAXIWAY A EXTENSION | 14 | CONSTRUCT NEW HANGAR LEASE AREA | 23 | ACQUIRE AIRPORT PROPERTY (APPROX. 1.2 ACRES) |
| 7 | RECONSTRUCT TAXIWAY C | 15 | CONSTRUCT NEW T-HANGAR LEASE AREA | 24 | CONSTRUCT NEW PAPI |
| 8 | REMOVE A PORTION OF EXISTING TAXIWAY D | 16 | CONSTRUCT NEW TRANSIENT AIRCRAFT PARKING APRON (10 TIE-DOWNS) | | |
| | | 17 | EXPAND NORTHEAST APRON (28 TIE-DOWNS) | | |

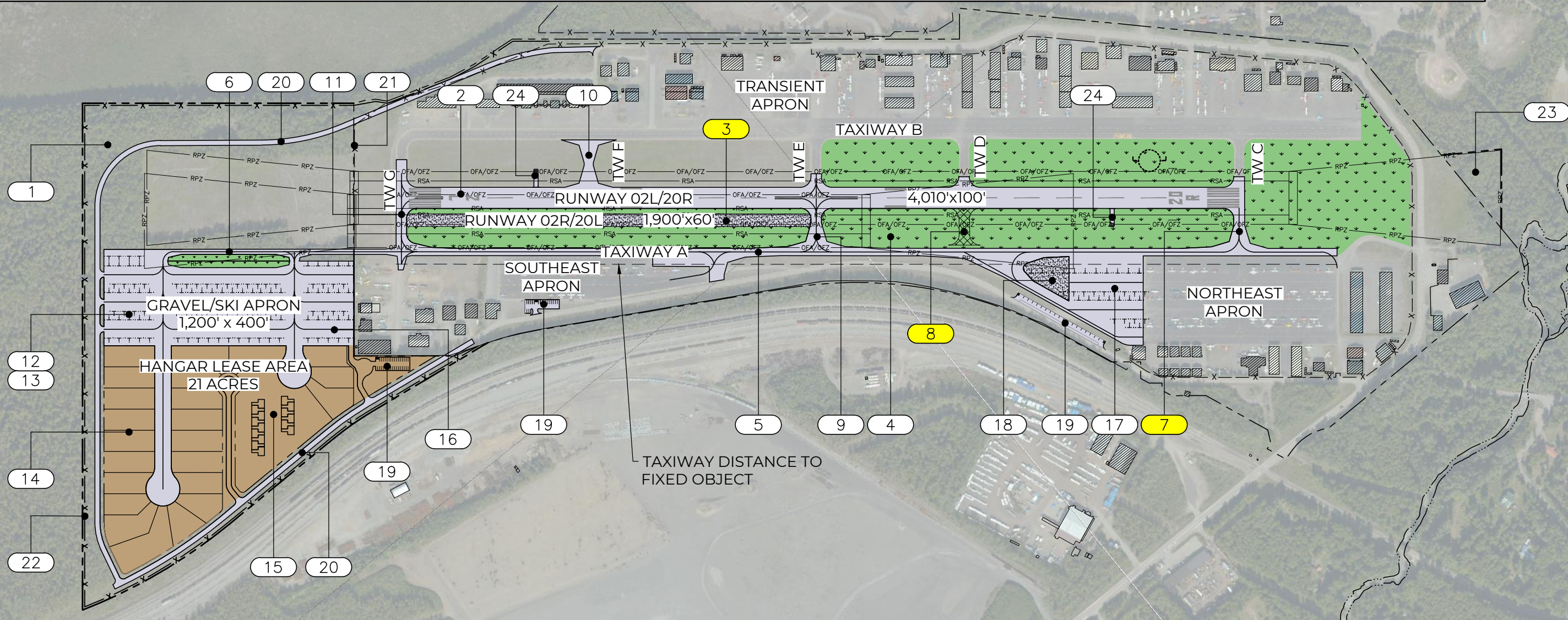

LEGEND

- | | | | |
|--|-------------------------------------|--|------------------------------------|
| | HANGAR DEVELOPMENT AREAS | | PROPOSED AIRPORT PROPERTY BOUNDARY |
| | NEW GRASS AREA | | NEW FENCE |
| | NEW PAVEMENT | | RUNWAY SAFETY AREA |
| | NEW GRAVEL SURFACE | | OBJECT FREE AREA/ZONE |
| | PARKING & PORTABLE PUBLIC RESTROOMS | | RUNWAY PROTECTION ZONE |
| | AIRCRAFT TIE-DOWN | | CHANGES COMPARED TO ALTERNATIVE 2 |

BIRCHWOOD AIRPORT MASTER PLAN		
EXHIBIT - ALTERNATIVE 3		
DEPARTMENT OF TRANSPORTATION AND PUBLIC FACILITIES/CR		
BIRCHWOOD, ALASKA		
DATE: 11-7-2022	DRAWN BY: TA/TC	SHEET: 3
SCALE: 1" = 250'	CHECKED BY: MS	JOB NO.: 20-014

ALTERNATIVE 4

- 1 ACQUIRE AIRPORT PROPERTY (APPROX. 175 ACRES)
- 2 RECONSTRUCT RUNWAY 02L/20R
- 3 CONSTRUCT NEW GRAVEL/SKI RUNWAY 02R/20L
- 4 CONVERT EXISTING RUNWAY 02R/20L TO TAXIWAY A
- 5 RECONSTRUCT TAXIWAY A
- 6 CONSTRUCT TAXIWAY A EXTENSION
- 7 RECONSTRUCT TAXIWAY C
- 8 CONSTRUCT NEW TAXIWAY F
- 9 CONSTRUCT NEW TAXIWAY S
- 10 CONSTRUCT NEW GRAVEL/SKI APRON (184 TIE-DOWNS)
- 11 INSTALL ELECTRIC OUTLETS AT NEW TIE-DOWNS
- 12 NEW HANGAR LEASE LOT AREA
- 13 NEW T-HANGAR LEASE AREA
- 14 CONSTRUCT NEW TRANSIENT AIRCRAFT PARKING APRON (10 TIE-DOWNS)
- 15 EXPAND NORTHEAST APRON (30 TIE-DOWNS)
- 16 EXPAND SOUTHEAST APRON
- 17 CONSTRUCT SUMMER AIRCRAFT TIE-DOWN AREA/WINTER SNOW STORAGE AREA (4 TIE-DOWNS)
- 18 DEVELOP NEW VEHICLE PARKING AREA WITH PORTABLE PUBLIC RESTROOM FACILITIES
- 19 CONSTRUCT ACCESS ROADS
- 20 REMOVE EXISTING FENCE
- 21 CONSTRUCT NEW PERIMETER FENCING
- 22 ACQUIRE AIRPORT PROPERTY (APPROX. 1.2 ACRES)
- 23 CONSTRUCT NEW PAPI

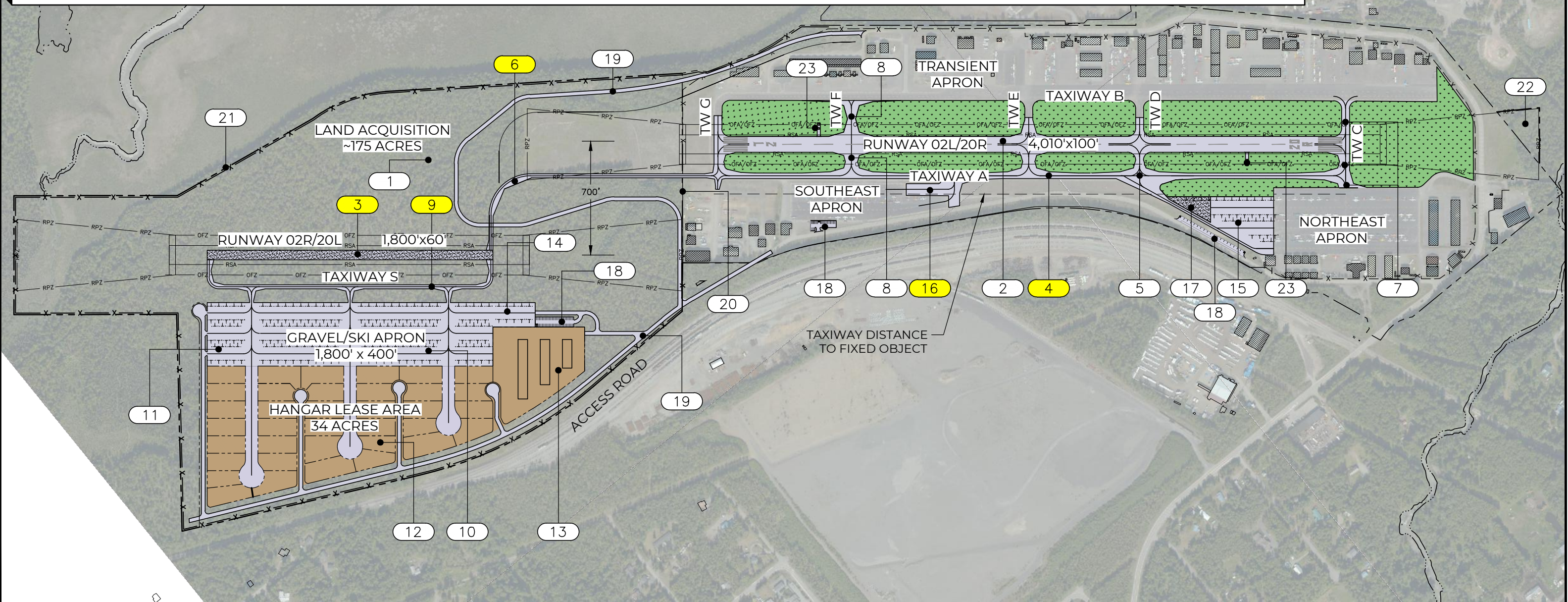

LEGEND

- HANGAR DEVELOPMENT AREAS
- NEW GRASS AREA
- NEW PAVEMENT
- NEW GRAVEL SURFACE
- PARKING & PORTABLE PUBLIC RESTROOMS
- AIRCRAFT TIE-DOWN
- PROPOSED AIRPORT PROPERTY BOUNDARY
- NEW FENCE
- RUNWAY SAFETY AREA
- OBJECT FREE AREA/ZONE
- RUNWAY PROTECTION ZONE
- CHANGES COMPARED TO ALTERNATIVE 3

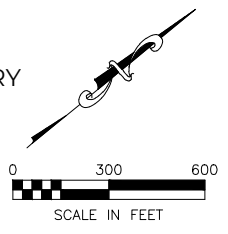

BIRCHWOOD AIRPORT MASTER PLAN		
EXHIBIT - ALTERNATIVE 4		
DEPARTMENT OF TRANSPORTATION AND PUBLIC FACILITIES/CR		
BIRCHWOOD, ALASKA		
DATE: 11-7-2022	DRAWN BY: TA/TC	SHEET: 4
SCALE: 1" = 300'	CHECKED BY: MS	JOB NO.: 20-014