



U.S. Department
of Transportation
**Federal Aviation
Administration**

Alaskan Region Airports Division

222 W. 7th Avenue, #14
Anchorage, Alaska 99513-7587
Tel. (907) 271-5438 / Fax (907) 271-2851

August 15, 2019

Jourde Mitchell
ADOT&PF Aviation Design
4111 Aviation Ave
Anchorage, AK 99519-6900

Dear Ms. Mitchell:

Hooper Bay Airport

**Hooper Bay, Alaska
As-Built Airport Layout Plan (26 July 2019)
(Original ALP Airspace #2012-AAL-114-NRA)**

We have completed our review of the Hooper Bay Airport As-Built Airport Layout Plan (ALP) dated 26 July, 2019, and find it acceptable for documenting the existing conditions of the airport.

Please retain this letter in your files for future reference.

Sincerely,

Pat Zettler, P.E., Lead Engineer
Airports Division

Date Plotted: 7/26/2019, 8:07 AM
 Layout Number: 14
 File Name: W:\Projects\Hooper Bay ALP\Drawings\14-1-ALP-ALP.dwg
 Designed By: CDL
 Drawn By: CDL
 Checked By:

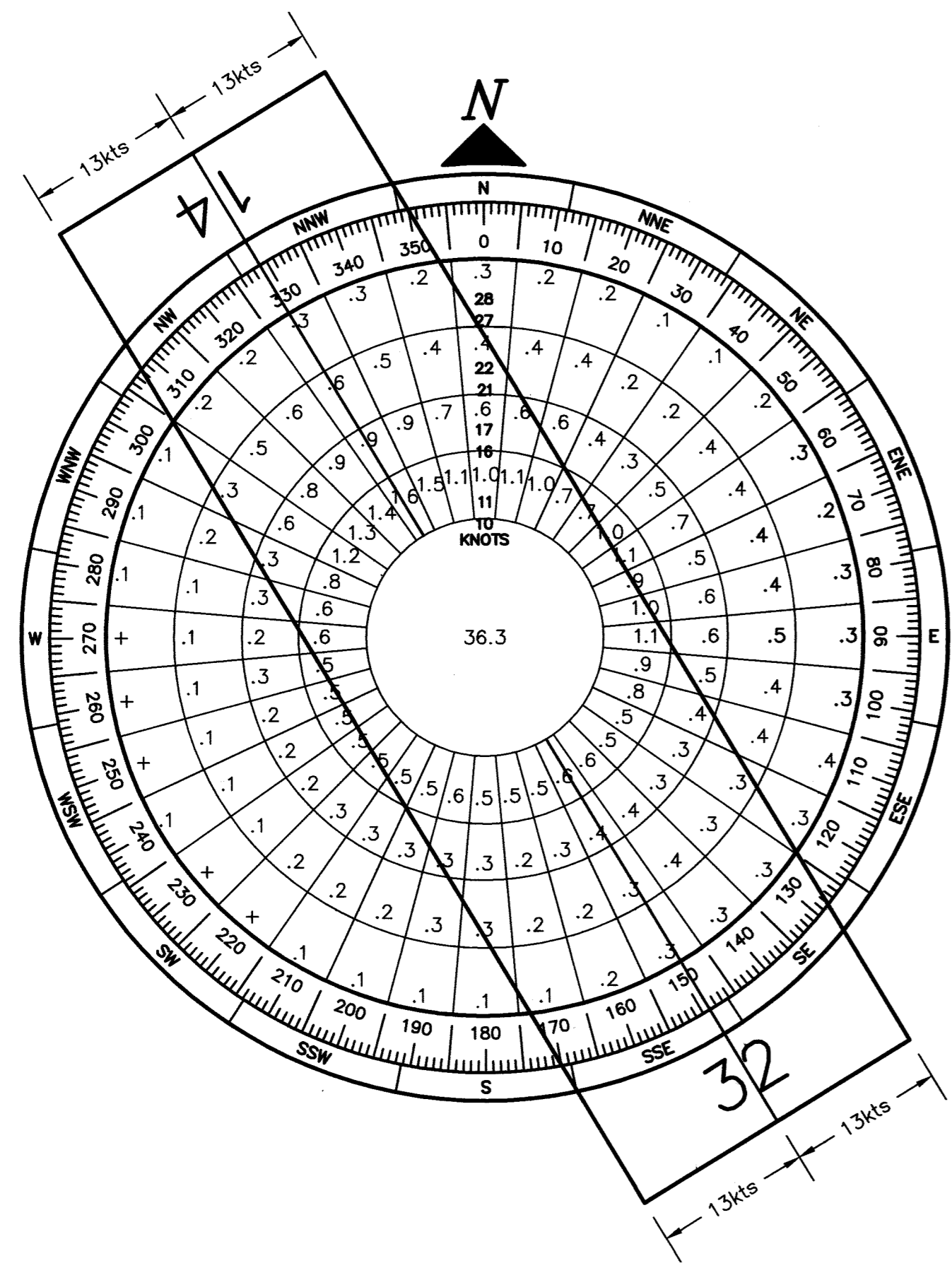
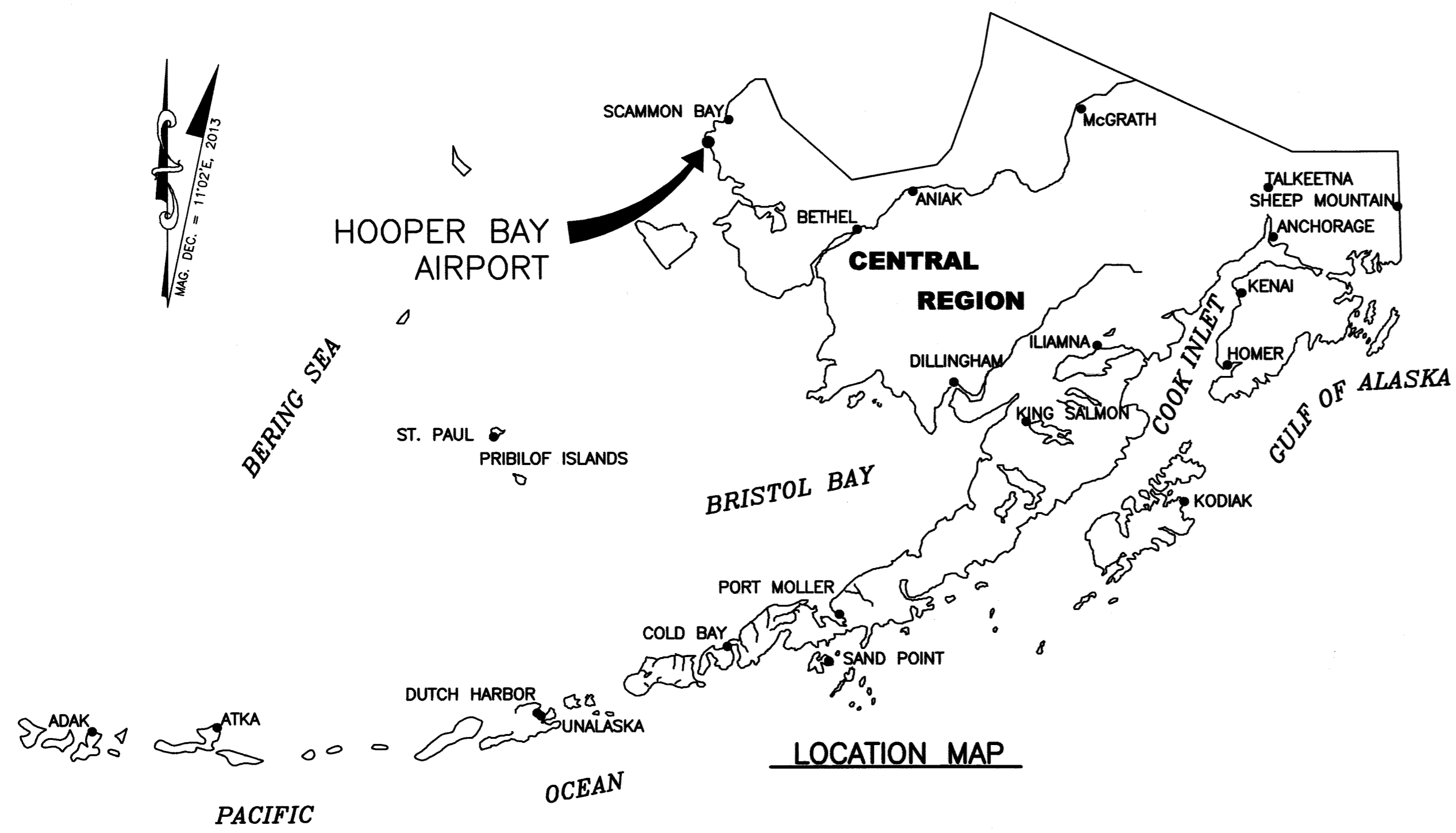

RUNWAY	10.5 kt	13 kt	16 kt	20 kt
14/32	68.42%	77.36%		

SOURCE: NATIONAL CLIMATIC DATA CENTER
 PERIOD: 2002-2012

ITEM	EXISTING	ULTIMATE
AIRPORT REFERENCE POINT (A.R.P.)		
ANTENNA		
APPROACH		
APPROACH SITING		
BUILDINGS		
BUILDING RESTRICTION LINE		
FAA WEATHER STATION		
FENCE		
PAPI		
PROPERTY LINE		
REIL		
ROADWAYS		
ROTATING BEACON		
RUNWAY OBSTACLE FREE AREA		
RUNWAY OBSTACLE FREE ZONE		
RUNWAY PROTECTION ZONE		
RUNWAY SAFETY AREA		
RUNWAY VISUAL ZONE		
SEGMENTED CIRCLE		
SHORELINE		
SURVEY MONUMENT		
THRESHOLD MARKERS/LIGHTS		
TOPOGRAPHIC CONTOURS		
UTILITY POLE		
VASI		
WATER BODY		
WIND CONE		
WIND TURBINE		

ITEM	EXISTING	ULTIMATE
ICAO IDENTIFIER	PAHP	PAHP
NATIONAL AIRPORT IDENTIFIER	HPB	HPB
FAA SITE NUMBER	50322.*A	50322.*A
AIRPORT ELEVATION NAVD88*	19.5	19.5
AIRPORT REFERENCE CODE	B-II	B-II
MEAN MAX. TEMPERATURE, HOTTEST MONTH	53°F, JULY	53°F, JULY
AIRPORT AND TERMINAL NAVIGATION AIDS	ROTATING BEACON	ROTATING BEACON
	VOR/DME	VOR/DME
	AWOS	AWOS
OBSTRUCTION SURVEY SOURCE & TYPE	VG	VG
MAGNETIC DECLINATION, YEAR, RATE OF CHANGE	11°02'E / 2013 -0°13'(W) / YEAR	

*VERTICAL DATUM: GEOID 12B

ITEM	EXISTING	ULTIMATE
RUNWAY IDENTIFIER	14/32	14/32
RUNWAY TYPE	UTILITY OR OTHER THAN UTILITY	UTILITY OR OTHER THAN UTILITY
FAR PART 77 APPROACH CATEGORY (V, NPI, P)	NPI / NPI	NPI / NPI
APPROACH SURFACES	20:1 / 20:1	34:1 / 34:1
VISIBILITY MINIMUM	> 1 SM	> 3/4 SM
RUNWAY SURFACE	GRAVEL	GRAVEL
PAVEMENT STRENGTH SW,DW,DTW,DDTW x1000lbs	N/A	N/A
RUNWAY REFERENCE CODE OR DESIGN CODE	B/II/4000 (RRC)	B/II/4000 (RDC)
DESIGN AIRCRAFT OVER 60,000 LBS	NO	NO
MAXIMUM ELEVATION NAVD88*	19.5	19.5
MEAN GEODETIC BEARING	N 31°21'34" W	N 31°21'34" W
EFFECTIVE GRADE	0.06%	0.04%
TOUCHDOWN ZONE ELEVATION NAVD88*	19.5 / 19.5	19.5 / 19.5
RUNWAY DIMENSIONS	75 x 3300	75 x 4500
RUNWAY SAFETY AREA (RSA) DIMENSIONS	150 x 3900	150 x 5100
LENGTH BEYOND R/W END	300 / 300	300 / 300
RUNWAY PROTECTION ZONE (RPZ) DIMENSIONS	500 x 700 x 1000	1000 x 1510 x 1700
RUNWAY OBJECT FREE AREA (OFA) DIMENSIONS	500 x 3900	500 x 5100
LENGTH BEYOND R/W END OR STOPWAY	300 / 300	300 / 300
RUNWAY OBSTACLE FREE ZONE (OFZ) DIMENSIONS	250 x 5235	400 x 6312
PRECISION OBSTACLE FREE ZONE (POFZ)	N/A	N/A
RUNWAY LIGHTING	MIRL	MIRL
RUNWAY MARKING TYPE	N/A	N/A
RUNWAY VISUAL AIDS	VASI, ODALS(32)	PAPI, REIL(14), MALSF(32)
RUNWAY NAVIGATIONAL AIDS	VOR/DME(32)	VOR/DME(32)
	GPS/WAAS	GPS/WAAS

*VERTICAL DATUM: GEOID 12B

ITEM	EXISTING	ULTIMATE
TAXIWAY DESIGN GROUP	II	II
TAXIWAY SURFACE	GRAVEL	GRAVEL
WIDTH x LENGTH	40 x 460	40 x 460
SHOULDER WIDTH	10	10
SEPARATION FROM PARALLEL RUNWAY	N/A	N/A
SAFETY AREA (TSA) WIDTH	79	79
OBJECT FREE AREA (TOFA) WIDTH	131	131
TAXIWAY LIGHTING	MITL	MITL
TAXIWAY MARKING	N/A	N/A

ITEM	EXISTING LATITUDE	EXISTING LONGITUDE	ULTIMATE LATITUDE	ULTIMATE LONGITUDE
ARP	61°31'26"N	166°08'48"W	61°31'20"N	166°08'40"W
THRESHOLD RW 14	61°31'39.81"N	166°09'05.55"W	61°31'38.55"N	166°09'03.95"W
THRESHOLD RW 32	61°31'12.06"N	166°08'30.14"W	61°31'00.71"N	166°08'15.68"W

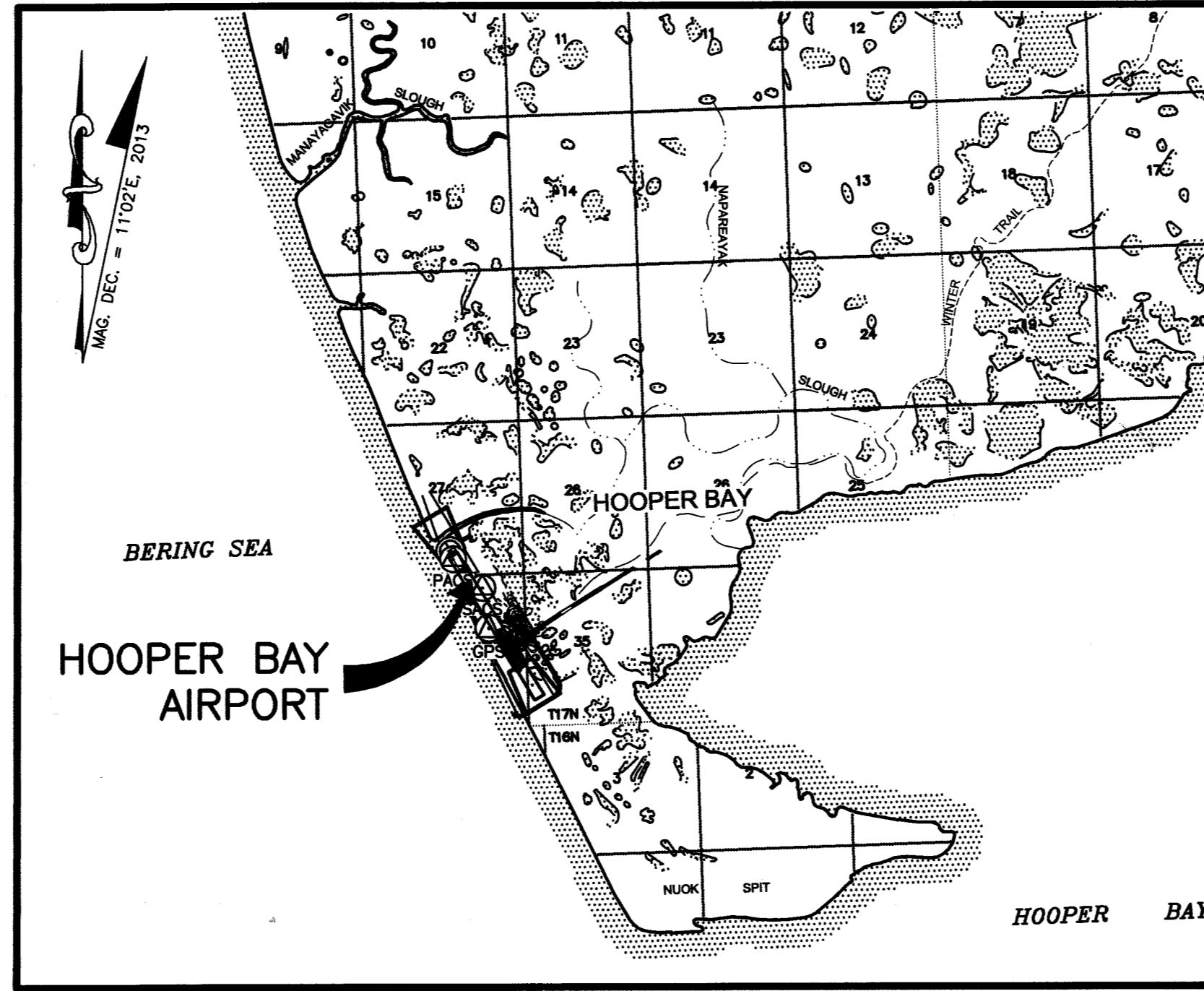

VICINITY MAP
 SECTIONS 26,27,34,35
 T16N, R93W, AND T17N, R93W, SEWARD MERIDIAN, ALASKA.
 U.S.G.S. HOOPER BAY (C-3) AND (C-4)

SHT #	TITLE
1	DATA
2	EXISTING LAYOUT
3	ULTIMATE LAYOUT
4	EXISTING INNER PORTION OF THE APPROACH SURFACE - RUNWAY 32
5	EXISTING INNER PORTION OF THE APPROACH SURFACE - RUNWAY 14
6	ULTIMATE INNER PORTION OF THE APPROACH SURFACE - RUNWAY 32
7	ULTIMATE INNER PORTION OF THE APPROACH SURFACE - RUNWAY 14
8	AIRPORT AIRSPACE, 14 CFR, PART 77
9	AIRPORT PROPERTY MAP

7/26/2019 PER AS-BUILT PROJECT Z574190000
 BY DATE REVISION
 APPROVED: DATE:
 KENNETH M. MORTON, P.E. PRECONSTRUCTION ENGINEER
 RECOMMENDED: DATE:
 WOLFGANG E. JUNGE DESIGN SECTION CHIEF
 AIRPORT LAYOUT PLAN CONDITIONAL APPROVAL SUBJECT TO ALP APPROVAL LETTER DATED 6/28/13
 FAA AIRSPACE REVIEW NUMBER: 2013-AAL-114-NRA
 AS-BUILT [Signature] DATE: 8/15/19
 FAA, AIRPORTS DIVISION ALASKAN REGION, AAL

STATE OF ALASKA
 DEPARTMENT OF TRANSPORTATION
 AND PUBLIC FACILITIES
 CENTRAL REGION
 HOOPER BAY AIRPORT
 HOOPER BAY, ALASKA
 AIRPORT LAYOUT PLAN
 DATA
 DATE: 8/19/2013
 SHEET: 1 OF 9

Date Plotted: 1/26/2019 7:59 AM
 Layout Name: 4 - EXT RW 32
 File Name: W:\Projects\Hooper Bay ALP\Drawings\57419-HB-EXISTING PROJ FILES.dwg
 Designed By: CJI
 Drawn By: RGB
 Checked By:

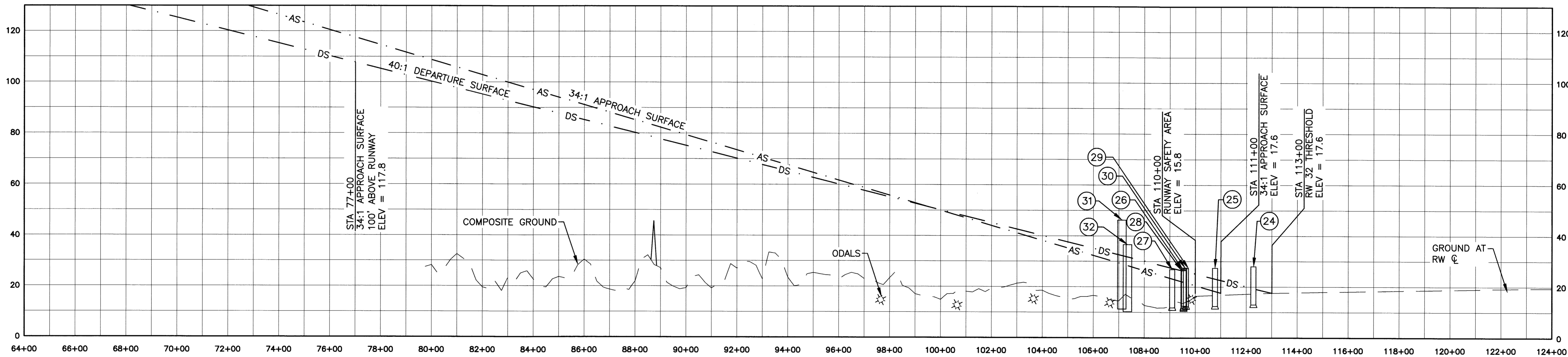
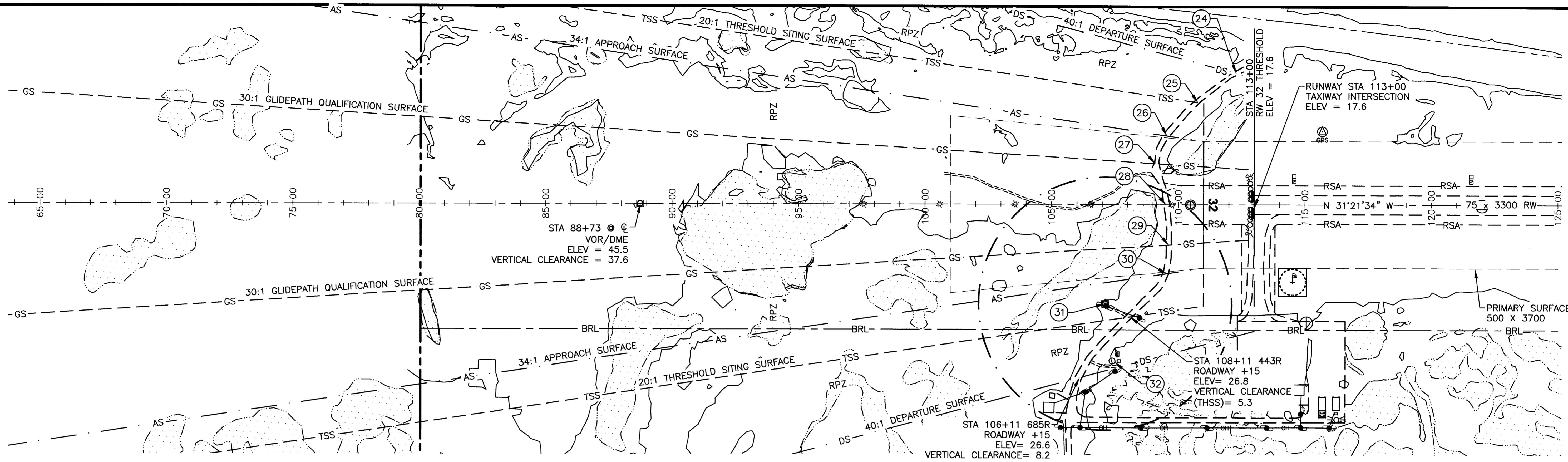

PART 77 SURFACE OBSTRUCTIONS (INNER PORTION RW 32)

ID #	DESCRIPTION	STATION/OFFSET	ELEVATION	SURFACE PENETRATED	SURFACE ELEVATION	AMOUNT PENETRATION	DISPOSITION	STAGE TO CORRECT
26	ROAD	109+54/272L	26.9	APPROACH	21.9	5.0	REMOVE	ULTIMATE
27	ROAD	109+09/162L	26.9	APPROACH	23.2	3.7	REMOVE	ULTIMATE
28	ROAD	109+52 @ CL	26.5	APPROACH	22.0	4.5	REMOVE	ULTIMATE
29	ROAD	109+63/159R	27.3	APPROACH	21.6	5.7	REMOVE	ULTIMATE
30	ROAD	109+55/272R	27.5	APPROACH	22.0	5.5	REMOVE	ULTIMATE

20:1 THRESHOLD SITING SURFACE PENETRATIONS (RW 32)

ID #	DESCRIPTION	STATION/OFFSET	ELEVATION	SURFACE PENETRATED	SURFACE ELEVATION	AMOUNT PENETRATION	DISPOSITION	STAGE TO CORRECT
25	ROAD	110+77/404L	27.4	20:1	18.8	8.6	REMOVE	ULTIMATE
26	ROAD	109+54/272L	26.9	20:1	24.9	2.0	REMOVE	ULTIMATE
28	ROAD	109+52 @ CL	26.5	20:1	25.0	1.5	REMOVE	ULTIMATE
29	ROAD	109+63/159R	27.3	20:1	24.5	2.8	REMOVE	ULTIMATE
30	ROAD	109+55/272R	27.5	20:1	24.9	2.6	REMOVE	ULTIMATE
31	AWOS	107+13/391R	46.3	20:1	37.0	9.3	NONE	ULTIMATE

40:1 DEPARTURE SURFACE PENETRATIONS (RW 13)

ID #	DESCRIPTION	STATION/OFFSET	ELEVATION	SURFACE PENETRATED	SURFACE ELEVATION	AMOUNT PENETRATION	DISPOSITION	STAGE TO CORRECT
24	ROAD	112+28/519L	28.0	DEPARTURE	19.4	8.6	REMOVE	ULTIMATE
25	ROAD	110+77/404L	27.4	DEPARTURE	23.2	4.2	REMOVE	ULTIMATE
26	ROAD	109+54/272L	26.9	DEPARTURE	26.3	0.6	REMOVE	ULTIMATE
28	ROAD	109+52 @ CL	26.5	DEPARTURE	26.3	0.2	REMOVE	ULTIMATE
29	ROAD	109+63/159R	27.3	DEPARTURE	26.0	1.3	REMOVE	ULTIMATE
30	ROAD	109+55/272R	27.5	DEPARTURE	26.2	1.3	REMOVE	ULTIMATE
31	AWOS	107+13/391R	46.3	DEPARTURE	32.3	14.0	NONE	ULTIMATE
32	ANICS	107+34/601R	36.6	DEPARTURE	31.7	4.9	NONE	ULTIMATE

NOTES:

- THE CONTROLLING OBSTRUCTION FOR RUNWAY 32 IS A ROAD AT STA 110+77/404L ELEV=27.4. THE OBSTRUCTION CLEARANCE SLOPE IS ESTABLISHED AS 2:1 PER FAA AC 150/5200-35A, CHAPTER 4, DATA ELEMENT 57.
- THRESHOLD SITING CRITERIA IS BASED ON AC 150/5300-13A, TABLE 3-2, LINES 6 AND 8.
- REFER TO THE AIRPORT AIRSPACE DRAWING FOR PENETRATIONS OF THE OUTER APPROACH SURFACES.
- DEPARTURE SURFACE AS DEFINED IN AC150/5300-13A, TABLE 3-2, LINE 9.

BY	DATE	REVISION
	7/26/2019	PER AS-BUILT PROJECT Z574190000

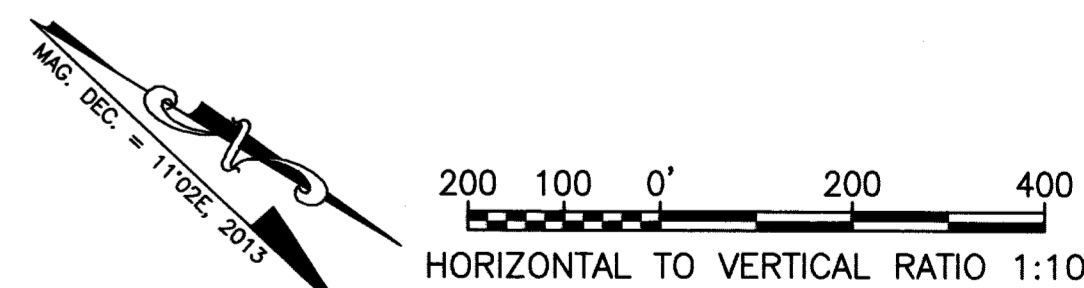

STATE OF ALASKA
DEPARTMENT OF TRANSPORTATION
AND PUBLIC FACILITIES
CENTRAL REGION

HOOPER BAY AIRPORT
 HOOPER BAY, ALASKA
 AIRPORT LAYOUT PLAN

EXISTING INNER PORTION OF THE
 APPROACH SURFACE - RUNWAY 32

DATE:
 8/19/2013
 SHEET:
 4 OF
 9

Date Plotted: 7/26/2019 7:59 AM
 Layout Name: 5 - EXT RW 14
 File Name: W:\Projects\Hooper Bay\ALP\Hooper Bay\ALP\Drawings\57419-HBB-EXISTING PROFILES.dwg
 Designed By: CDI
 Drawn By: RIG
 Checked By:

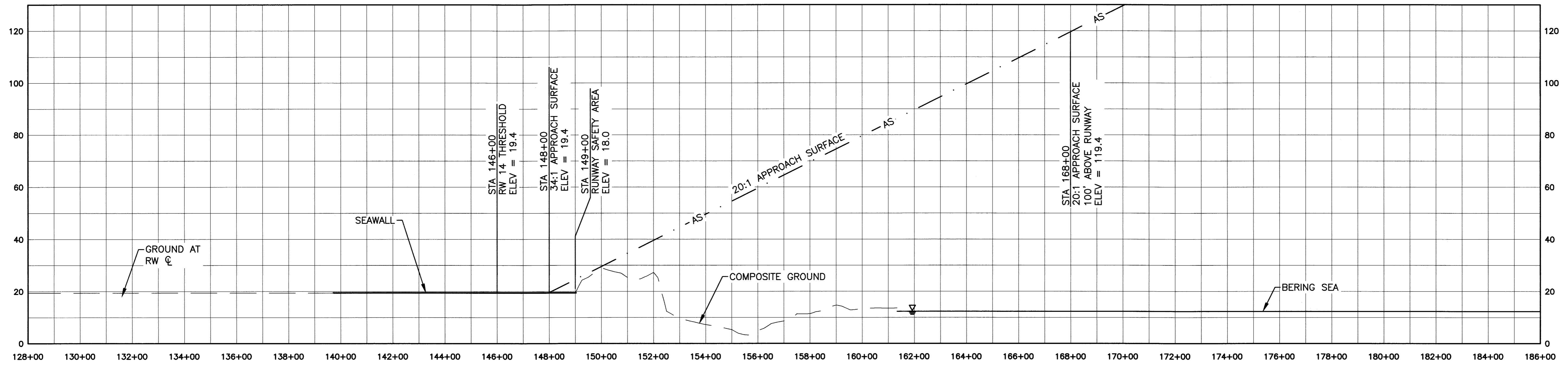
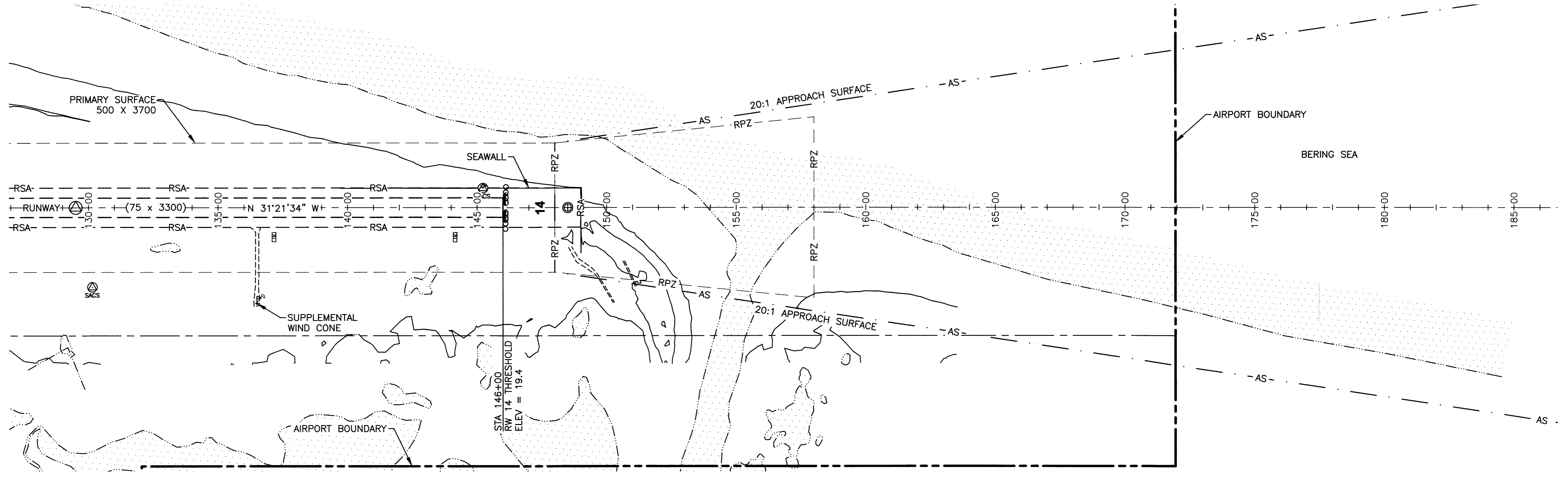

PART 77 SURFACE OBSTRUCTIONS TABLE (INNER PORTION RW 14)								
ID #	DESCRIPTION	STATION/OFFSET	ELEVATION	SURFACE PENETRATED	SURFACE ELEVATION	AMOUNT PENETRATION	DISPOSITION	STAGE TO CORRECT
	NONE							

- NOTES:
1. THERE ARE NO CONTROLLING OBSTRUCTIONS FOR RUNWAY 14. THE OBSTRUCTION CLEARANCE SLOPE IS ESTABLISHED AS 34:1 PER FAA AC 150/5200-35A, CHAPTER 4, DATA ELEMENT 57.
 2. THERE ARE NO THRESHOLD SITING SURFACE OBJECT PENETRATIONS. THRESHOLD SITING CRITERIA IS BASED ON AC 150/5300-13A, TABLE 3-2, LINES 6 AND 9.
 3. REFER TO THE AIRPORT AIRSPACE DRAWING FOR PENETRATIONS OF THE OUTER APPROACH SURFACES.
 4. NO DEPARTURE SURFACE PENETRATIONS.

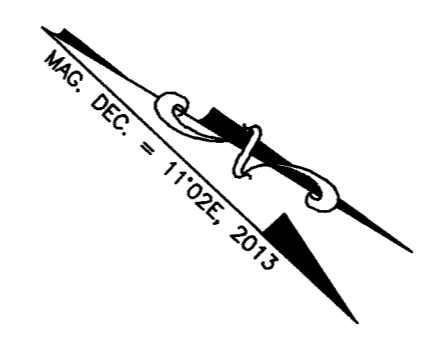

200 100 0' 200 400
 HORIZONTAL TO VERTICAL RATIO 1:10

BY	DATE	REVISION
	7/26/2019	PER AS-BUILT PROJECT Z574190000

STATE OF ALASKA
DEPARTMENT OF TRANSPORTATION
AND PUBLIC FACILITIES
CENTRAL REGION

HOOPER BAY AIRPORT
 HOOPER BAY, ALASKA
 AIRPORT LAYOUT PLAN

EXISTING INNER PORTION OF THE
 APPROACH SURFACE - RUNWAY 14

DATE:
8/19/2013
 SHEET:
5 OF 9

Date Plotted: 7/26/2019 7:50 AM
 Layout Name: 7 - UL1 - RW 14
 File Name: W:\Projects\Hooper Bay\AUP_2013\Hooper Bay_AUP_2013_R1\AUP Drawings\57419-HB-UL1\AUP PROFILES.dwg
 Designed By: CDL
 Drawn By: CDL
 Checked By:

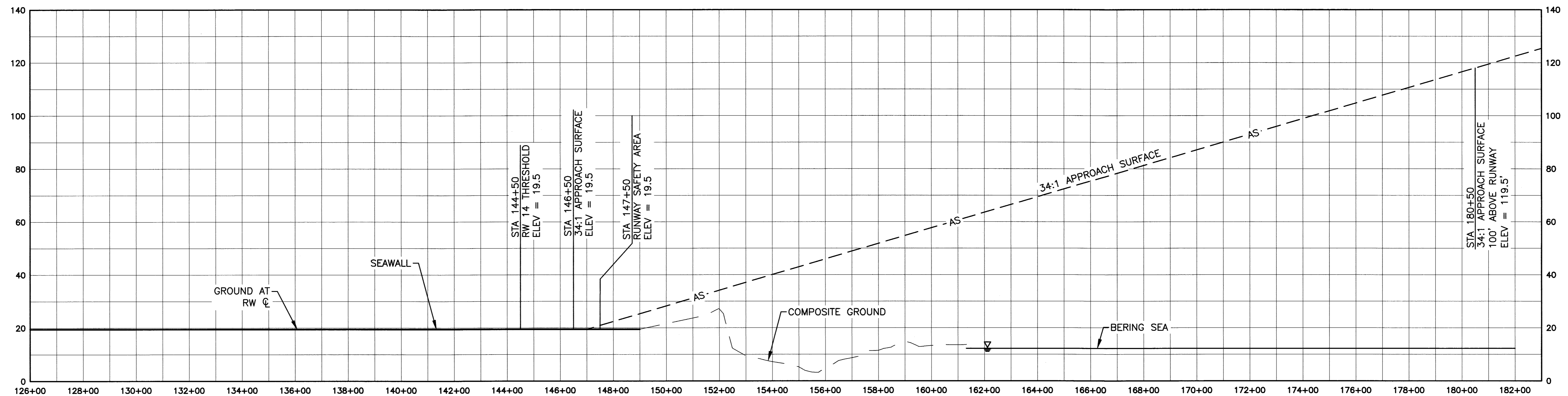
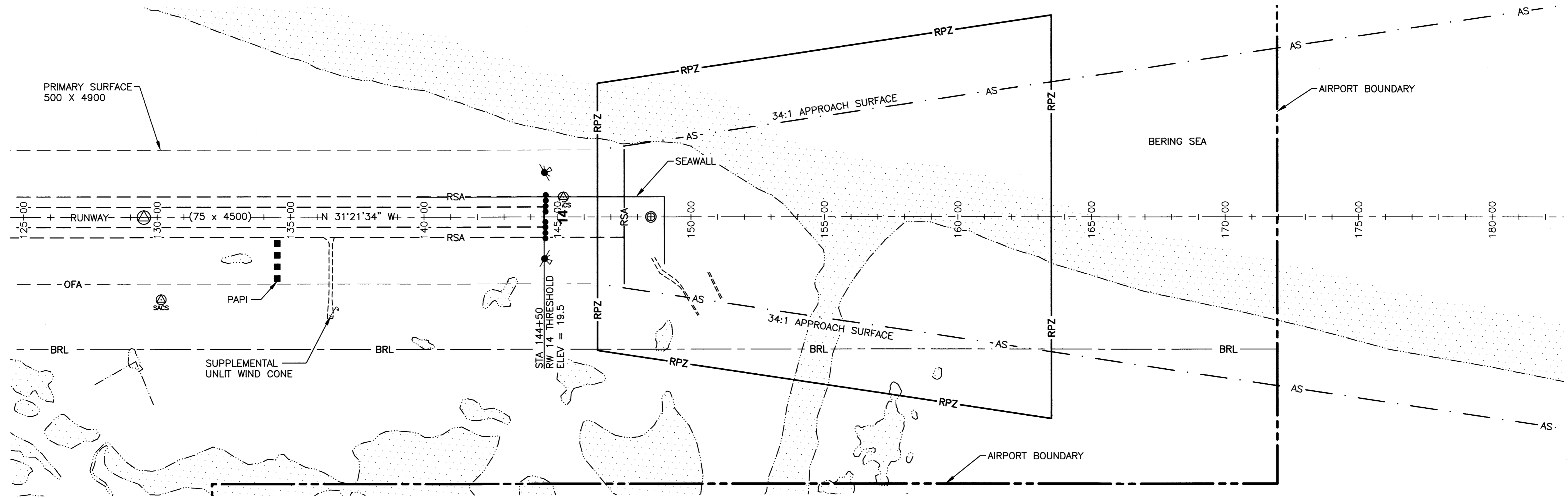

ID #	DESCRIPTION	STATION/OFFSET	ELEVATION	SURFACE PENETRATED	SURFACE ELEVATION	AMOUNT PENETRATION	DISPOSITION	STAGE TO CORRECT
	NONE							

NOTES:
 1. THERE ARE NO CONTROLLING OBSTRUCTIONS FOR RUNWAY 14. THE OBSTRUCTION CLEARANCE SLOPE IS ESTABLISHED AS 34:1 PER FAA AC 150/5200-35A, CHAPTER 4, DATA ELEMENT 57.
 2. THERE ARE NO THRESHOLD SITING SURFACE OBJECT PENETRATIONS. THRESHOLD SITING CRITERIA IS BASED ON AC 150/5300-13A, TABLE 3-2, LINES 6 AND 8.
 3. REFER TO THE AIRPORT AIRSPACE DRAWING FOR PENETRATIONS OF THE OUTER APPROACH SURFACES.
 4. NO DEPARTURE SURFACE PENETRATIONS.

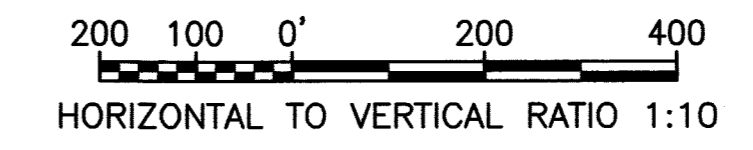

BY	DATE	REVISION
	7/26/2019	PER AS-BUILT PROJECT Z574190000

STATE OF ALASKA
DEPARTMENT OF TRANSPORTATION
AND PUBLIC FACILITIES
CENTRAL REGION

HOOPER BAY AIRPORT
 HOOPER BAY, ALASKA
 AIRPORT LAYOUT PLAN

ULTIMATE INNER PORTION OF THE
 APPROACH SURFACE - RUNWAY 14

DATE: 8/19/2013
 SHEET: 7 OF 9

Date Plotted: 7/26/2019, 7:49 AM
 Layout Name: 8 - AIRSPACE
 File Name: W:\Projects\Hooper Bay\ALP Drawings\57419-HB-AIRSPACE.dwg
 Designed By: CDL
 Drawn By: CDL
 Checked By:

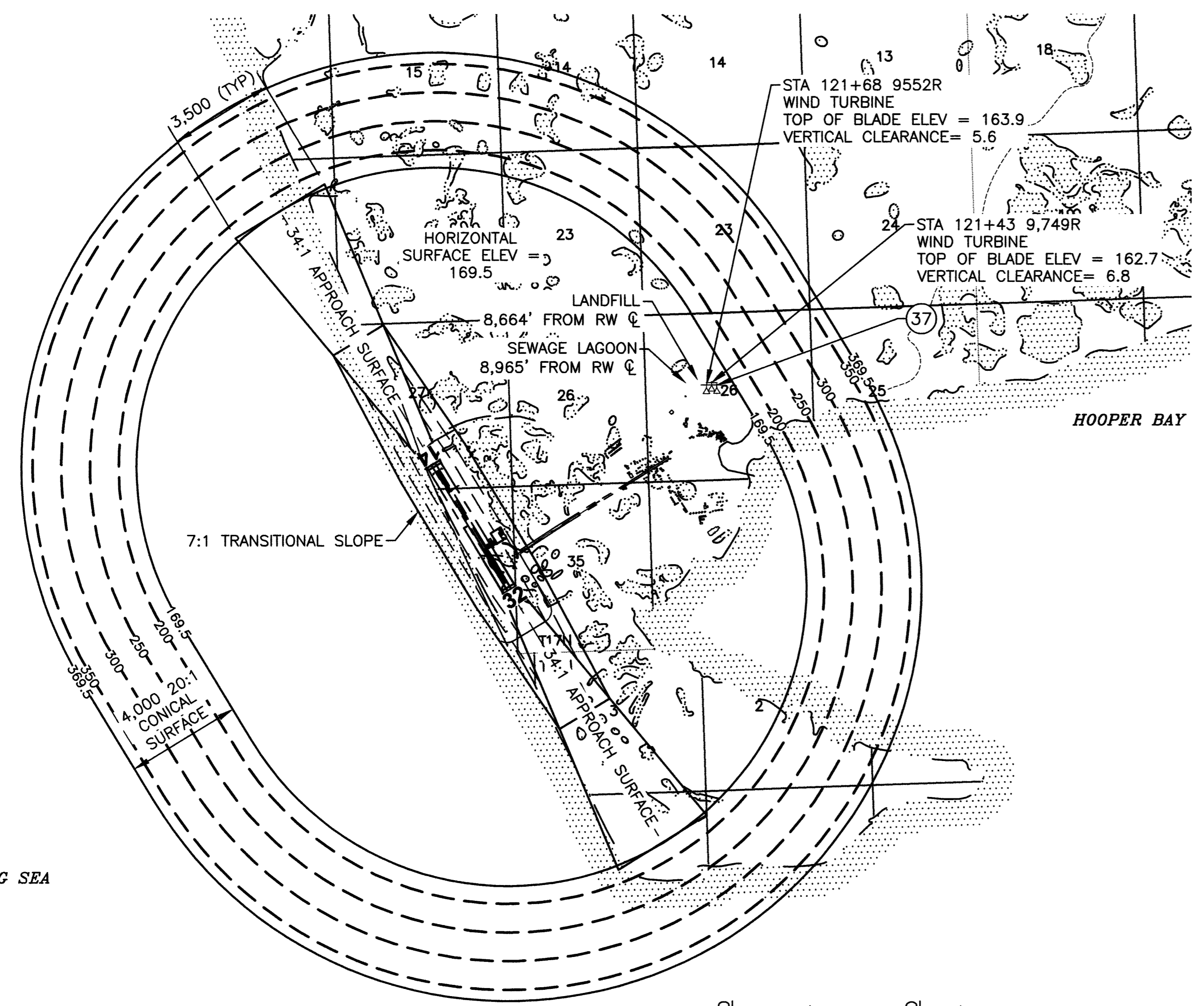

PART 77 SURFACE OBSTRUCTIONS TABLE (OUTER PORTION)								
ID #	DESCRIPTION	STATION/OFFSET	ELEVATION	SURFACE PENETRATED	SURFACE ELEVATION	AMOUNT PENETRATION	DISPOSITION	STAGE TO CORRECT
37	WINDMILL	119+86/9869R	174.2	HORIZONTAL	169.5	4.7	NONE	N/A

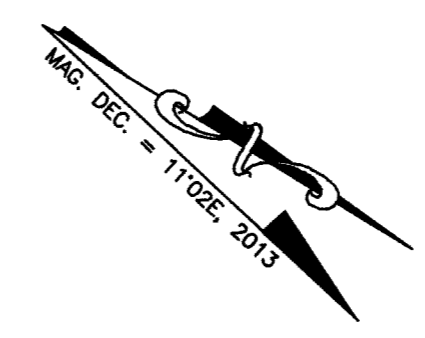
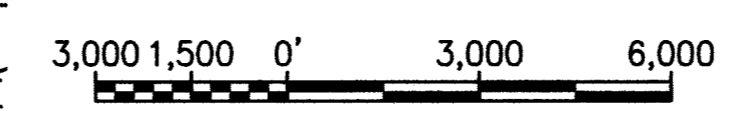

NOTES:

- ESTABLISHED AIRPORT ELEVATION IS 19.5.
- APPROACH SURFACES ARE 34:1 BEGINNING AT 200' FROM THE THRESHOLDS.
- BASE MAP DATA FROM USGS QUAD, HOOPER BAY, C-4.
- WIDTH OF PRIMARY SURFACE IS 500'.
- REFER TO THE INNER PORTION OF THE APPROACH SURFACE DRAWINGS FOR CLOSE IN OBSTRUCTIONS.
- THERE ARE NO KNOWN HEIGHT RESTRICTIONS.

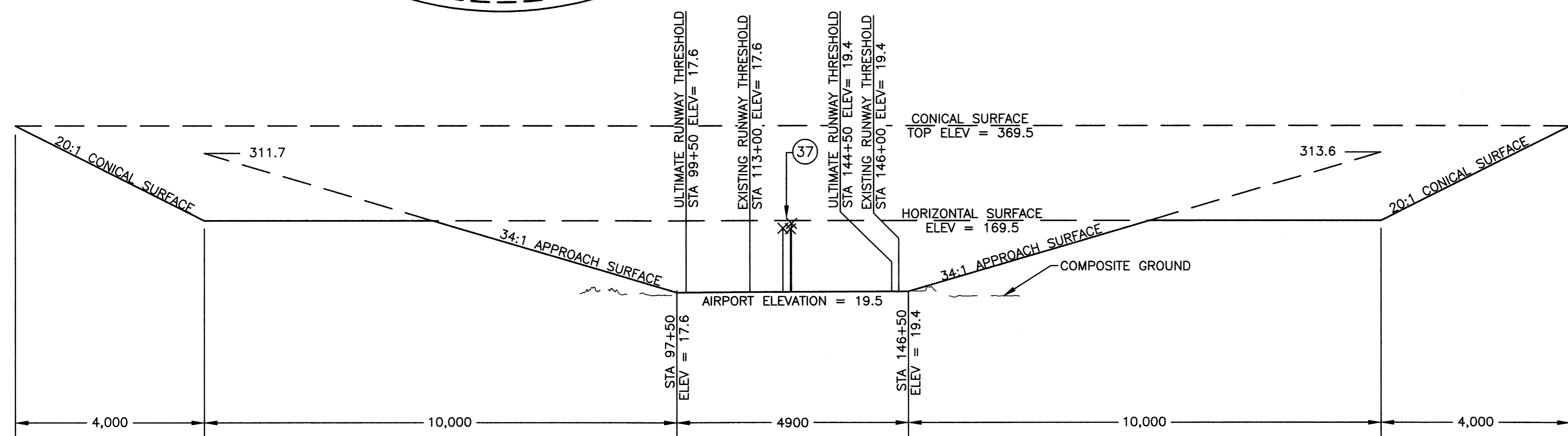

RUNWAY PROFILE
 HORIZONTAL TO VERTICAL RATIO 1:10

STATE OF ALASKA
DEPARTMENT OF TRANSPORTATION
AND PUBLIC FACILITIES
CENTRAL REGION

HOOPER BAY AIRPORT
 HOOPER BAY, ALASKA
 AIRPORT LAYOUT PLAN

AIRPORT AIRSPACE, 14 CFR,
 PART 77

DATE:
 8/19/2013
 SHEET:
 8
 OF
 9

BY	DATE	REVISION

7/26/2019 PER AS-BUILT PROJECT Z574190000

Date Plotted: 7/26/2019, 7:45 AM
 Layout Name: 9 - PROPERTY MAP
 File Name: W:\Projects\Hooper Bay\ALP Drawings\57419-HB-PROPERTY.dwg
 Designed By: CDL
 Drawn By: CDL
 Checked By:

ALASKA MARITIME
NATIONAL WILDLIFE
REFUGE

BERING SEA

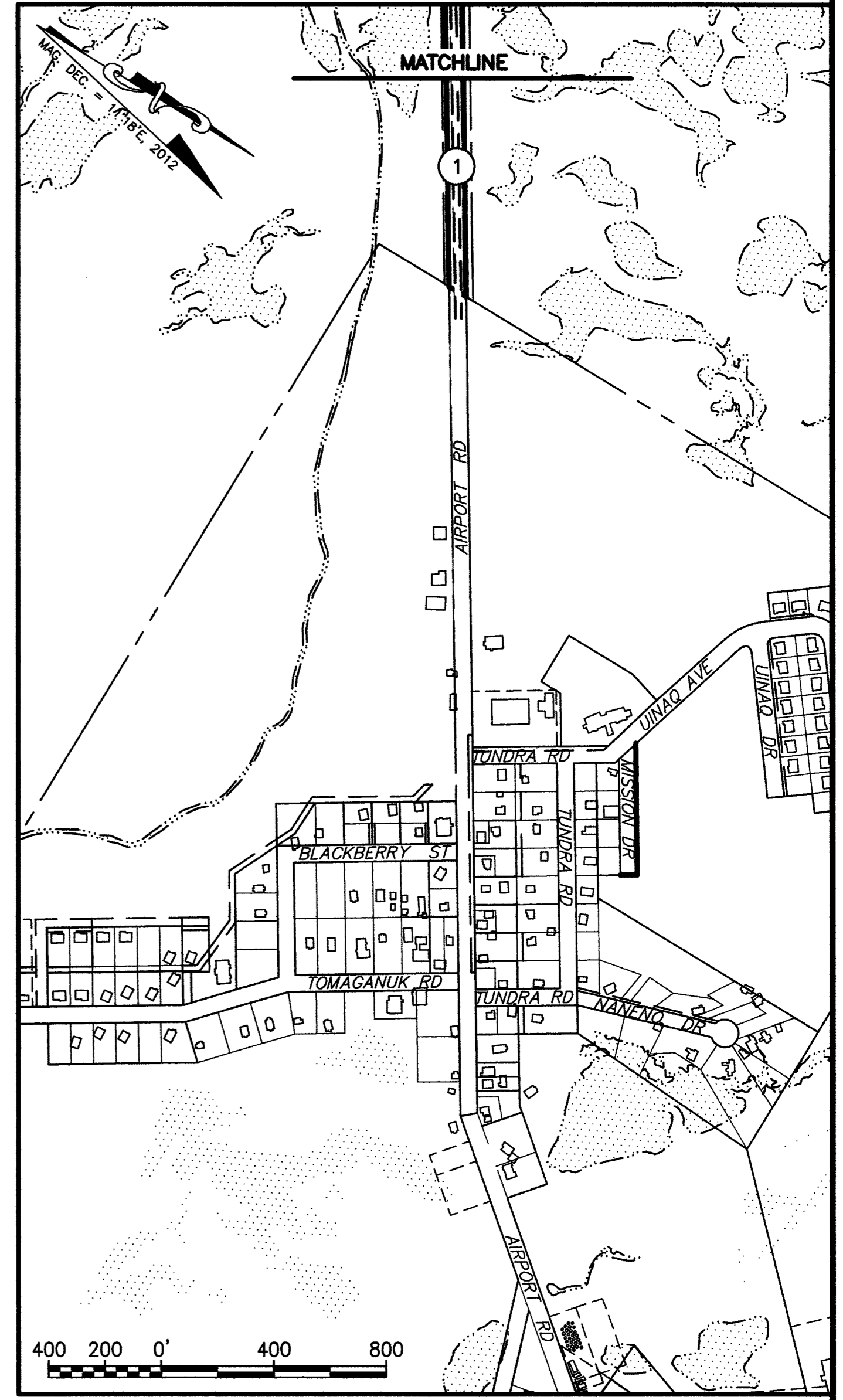
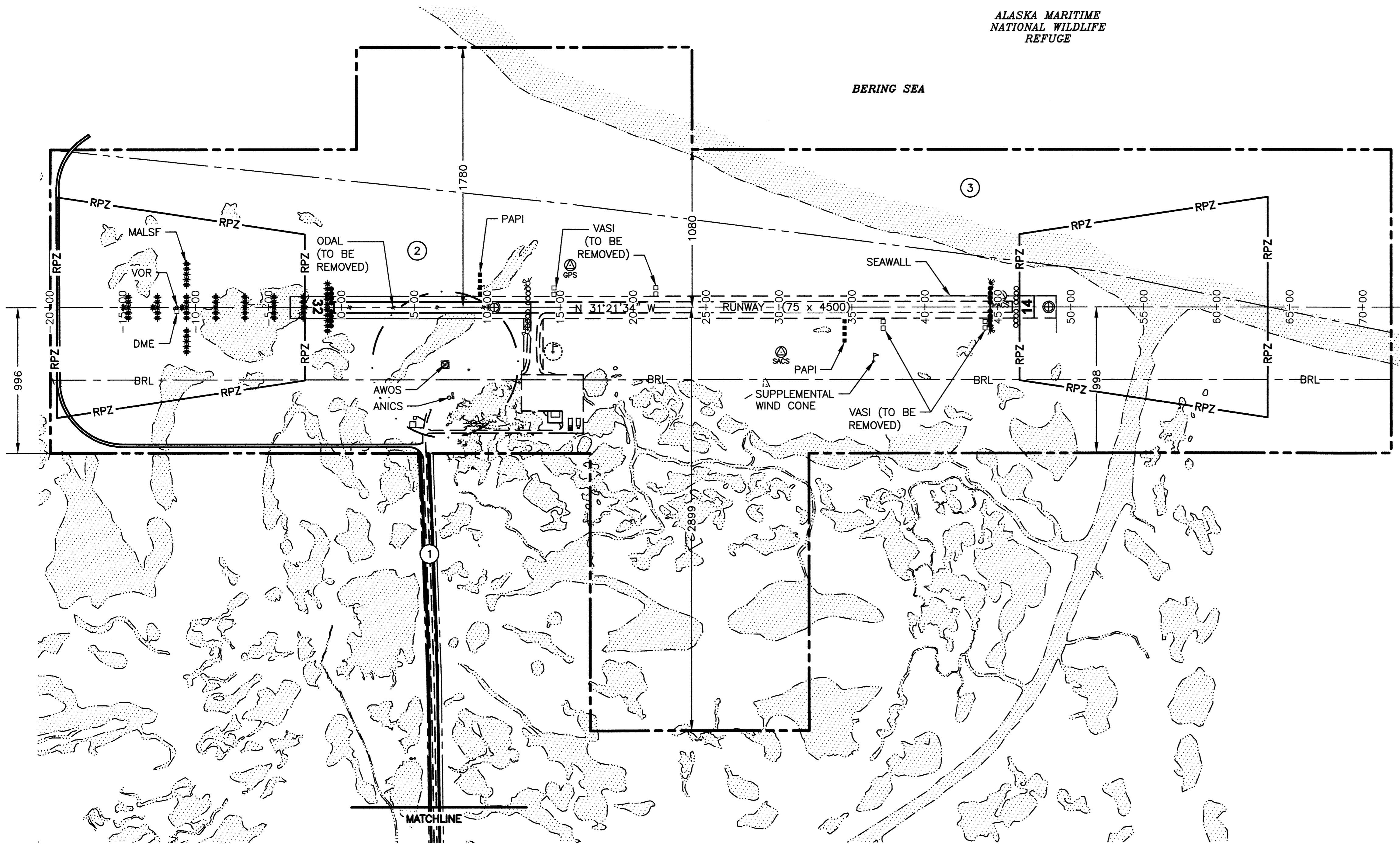

- NOTES:**
- THIS DRAWING WAS PREPARED FROM THE SURVEY CONTROL DIAGRAM DATED 7/6/2005, THE PROPERTY PLAN DATED 3/15/1972, REVISED ON 4/11/1975, AND DCCD MAPPING PREPARED MAY 2007.
 - AIRPORT IS LOCATED WITHIN THE BETHEL RECORDING DISTRICT.

- LEGEND**
- AIRPORT PROPERTY BOUNDARY
 - PARCEL BOUNDARY

PROPERTY STATUS								
ID #	INTEREST	GRANTOR	GRANTEE	PARCEL SIZE	DATE ACQUIRED	RECORDED DOC NO.	ACQUIRED AIP NO.	DATE OF LEASE/EASEMENT EXPIRATION
①	100' RIGHT OF WAY EASEMENT	RS 2477	STATE OF ALASKA, DOT/PF	7.31 ACRES	1/18/1958	N/A		N/A
②	FEDERAL PATENT #1235732	US OF A, DOI	STATE OF ALASKA, DOT/PF	390.39 ACRES	04/14/1964	2005-001109-0 BRD		N/A
③	ILMT	STATE OF ALASKA, DNR	STATE OF ALASKA, DOT/PF	150.42 ACRES	02/02/1973	BK 27 PG 410		N/A

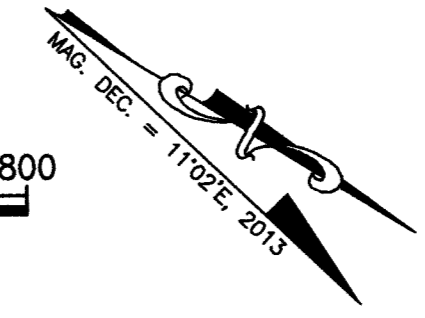

BY	DATE	REVISION
	7/26/2019	PER AS-BUILT PROJECT Z574190000

**STATE OF ALASKA
DEPARTMENT OF TRANSPORTATION
AND PUBLIC FACILITIES
CENTRAL REGION**

HOOPER BAY AIRPORT
HOOPER BAY, ALASKA
AIRPORT LAYOUT PLAN
AIRPORT PROPERTY MAP

DATE: 8/19/2013
SHEET: 9 OF 9