

ALP

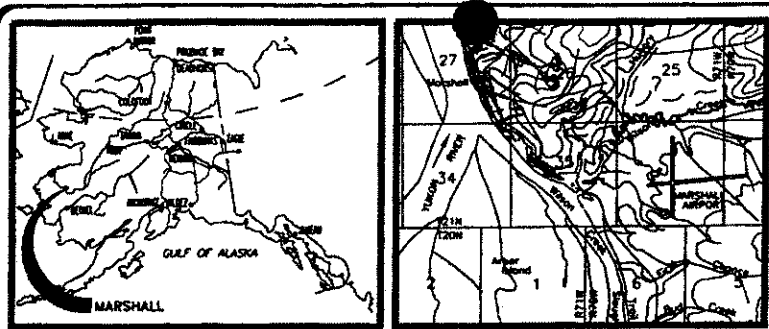

LOCATION MAP  
NO SCALE

VICINITY MAP  
S 36, T 21 N, R 70 W  
SEWARD MERIDIAN  
USGS MARSHALL (0-1) 1952

AIRPORT DATA		
	EXISTING	ULTIMATE
AIRPORT ELEVATION MWD 88	102.6'	119.2
AIRPORT REFERENCE CODE	B-1	SAME
WIND HIGH TEMP. HOTTEST MONTH (JULY)	84°F	SAME
TAXIWAY LIGHTING	MFL	SAME
RAMP LIGHTING	NONE	SAME
NAVIGATION AIDS	NONE	GPS
COMMUNICATION AIDS	NONE	SAME
AIRPORT REFERENCE POINT (ARP)	LAT. 61°51'32.82"N LONG. 162°01'28.21"W	
R/W 7-25 STA. 218+91.45, 154.95' LT.	LAT. 61°51'49.86"N LONG. 162°02'07.23"W	
THRESHOLD 25: STA. 232+00	LAT. 61°51'52.43"N LONG. 162°01'00.76"W	61°51'53.97"N 162°00'23.34"W
ULTIMATE STA. 250+00		
THRESHOLD 34: STA. 100+00	LAT. 61°51'34.36"N LONG. 162°01'44.37"W	
THRESHOLD 16: STA. 140+00	LAT. 61°52'13.75"N LONG. 162°01'44.35"W	

RUNWAY DATA			
	EXISTING	ULTIMATE	ULTIMATE
EFFECTIVE GRADIENT	0.98%	SAME	0.43%
% WIND COVERAGE	96.2%	SAME	88.1%
INSTRUMENT RUNWAY	NONE	NP	NONE
RUNWAY SURFACE TYPE	GRAVEL	SAME	GRAVEL
APPROACH SURFACES	34:1/34:1	SAME	20:1/20:1
APPROACH VISIBILITY MINIMUM	> 3/4 MILE	SAME	≥ 1 MILE
PAVEMENT STRENGTH	N/A	SAME	N/A
RUNWAY LIGHTING	MFL	SAME	MFL
RUNWAY MARKING	NONE	SAME	NONE
VISUAL APPROACH AIDS	BEACON	BEACON REL.	NONE
R/W DIMENSIONS	3200' X 100'	5000' X 100'	4000' X 100'
R/W SAFETY AREA	3800' X 150'	5600' X 150'	4600' X 140'
R/W OBJECT FREE AREA (OFA)	3800' X 500'	5600' X 500'	4600' X 400'
R/W OBJECT FREE ZONE (OFZ)	3800' X 400'	5400' X 400'	4400' X 300'
T/W WIDTH	50'	50'	NONE
T/W SAFETY AREA WIDTH	120'	120'	NONE
T/W OBJECT FREE AREA	131'	186'	NONE

LEGEND		
	EXISTING	ULTIMATE
PROPERTY LINE	---	---
BUILDING RESTRICTION LINE (B.R.L.)	---	---
DEVELOPMENT	---	---
WIND CONE & SEGMENTED CIRCLE R/W STA. 204+40, 443' LT.	---	---
BUILDING	---	---
ROADWAY	---	---
AIRPORT REFERENCE POINT	○	○
SHORELINE/WATERLINE	---	---
WINDING BEACON	○	○
TREELINE	---	---
MONUMENT	○	○
THRESHOLD	---	---

- NOTES
1. NO OFZ OBJECT PENETRATIONS.
  2. NO THRESHOLD SITING SURFACE OBJECT PENETRATIONS.
  3. ALASKA STATE PLANE GRID BEARING FOR R/W 7-25 IS N 85°00'00" E
  4. AIRSPACE REVIEW NO. 98AAL-06928RA
  5. DATA BASE CONTROL YEAR: MAD 83
  6. AREA TO BE ACQUIRED IN THE FUTURE.

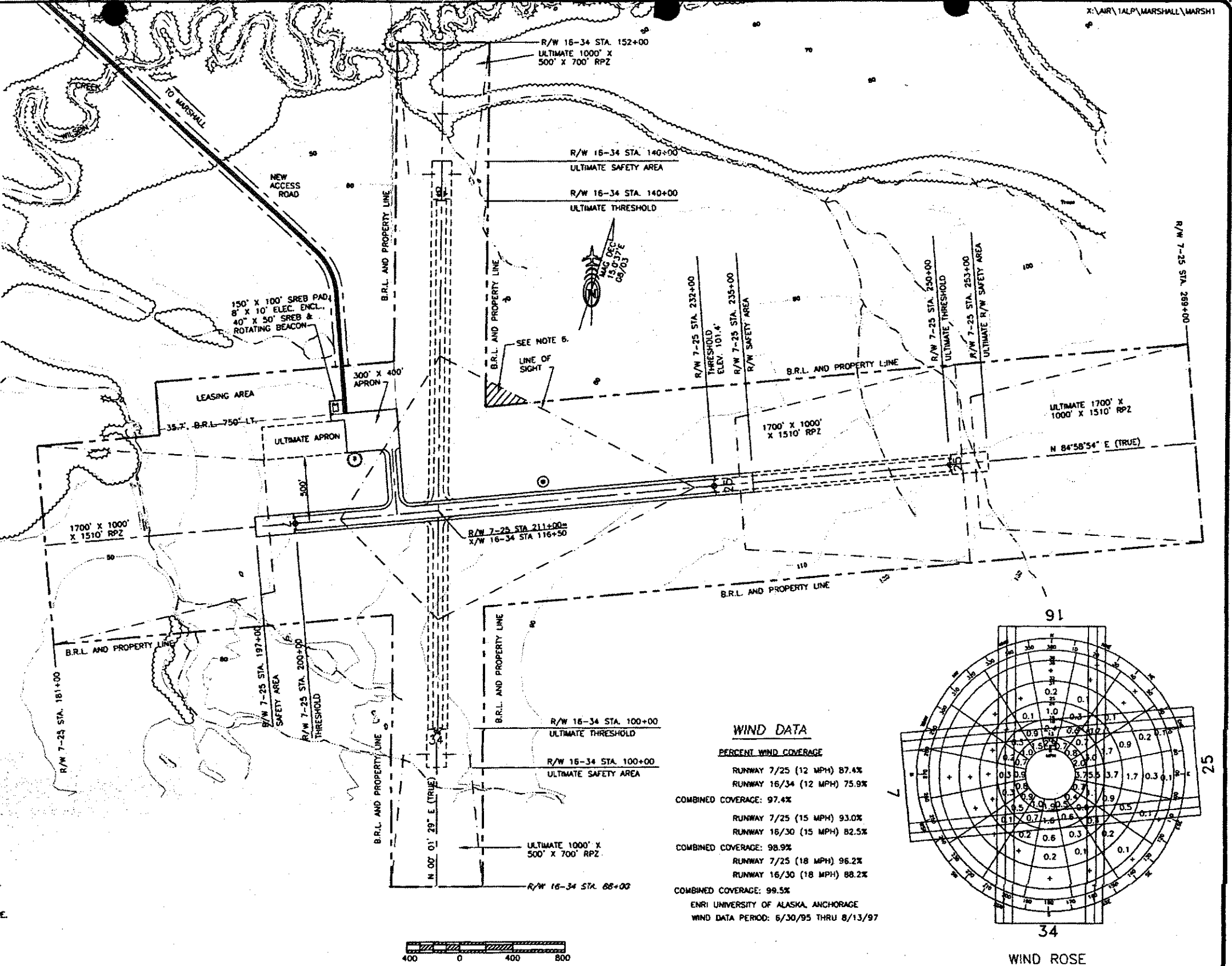

WIND DATA

PERCENT WIND COVERAGE

RUNWAY 7/25 (12 MPH)	87.4%
RUNWAY 16/34 (12 MPH)	75.9%
COMBINED COVERAGE:	97.4%
RUNWAY 7/25 (15 MPH)	93.0%
RUNWAY 16/30 (15 MPH)	82.5%
COMBINED COVERAGE:	98.9%
RUNWAY 7/25 (18 MPH)	96.2%
RUNWAY 16/30 (18 MPH)	88.2%
COMBINED COVERAGE:	99.5%

ENRI UNIVERSITY OF ALASKA, ANCHORAGE  
WIND DATA PERIOD: 6/30/95 THRU 8/13/97

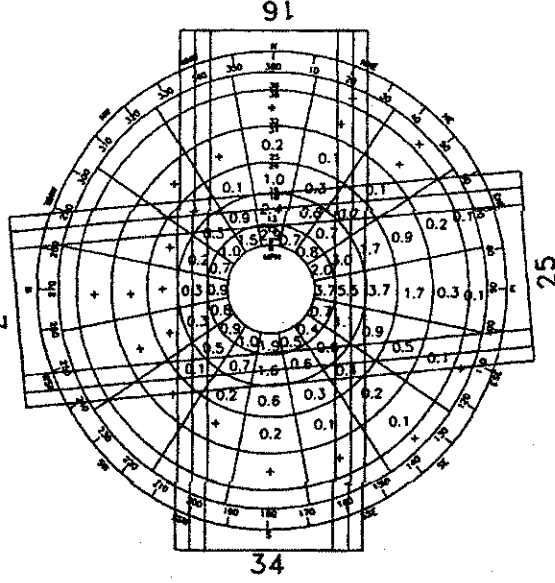

DESIGN	ENG
DRAWN	CAT
CHECKED	PDM

BY	DATE	REVISIONS
	8/29/03	FAA APPROVED
	8/18/03	AS-BUILT
	7/31/98	FAA APPROVED

STATE OF ALASKA  
DEPARTMENT OF TRANSPORTATION AND PUBLIC FACILITIES  
NORTHERN REGION-DESIGN AND CONSTRUCTION-AVIATION

APPROVED  
*Patricia D. Miller* DATE 8/27/03  
PATRICIA E. MILLER, P.E. DESIGN GROUP CHIEF

LAYOUT PLAN Conditionally Approved:  
By *John J. Lovell*  
AIRPORTS DIVISION, ALASKAN REGION  
Date 8/29/03

THIS ALP SUPERCEDES THE ALP DATED 7/31/98  
AND BASED ON THE AS-BUILTS

DON HUNTER SR.  
MARSHALL AIRPORT  
AIRPORT LAYOUT PLAN

SHEET  
1 OF  
4

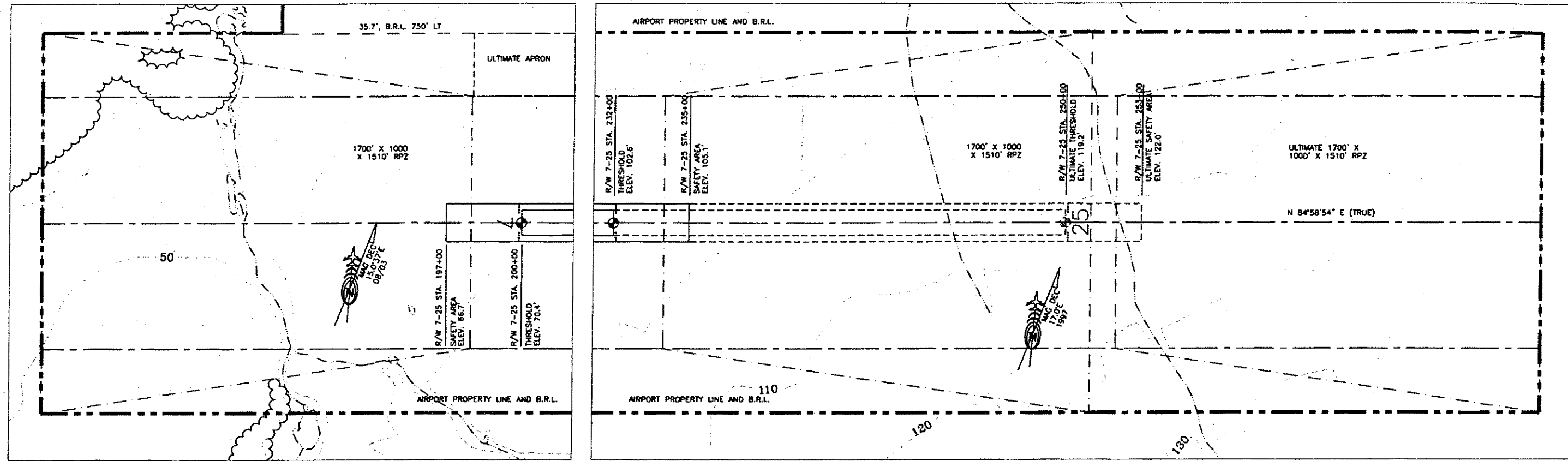

RPZ 7



RPZ 25

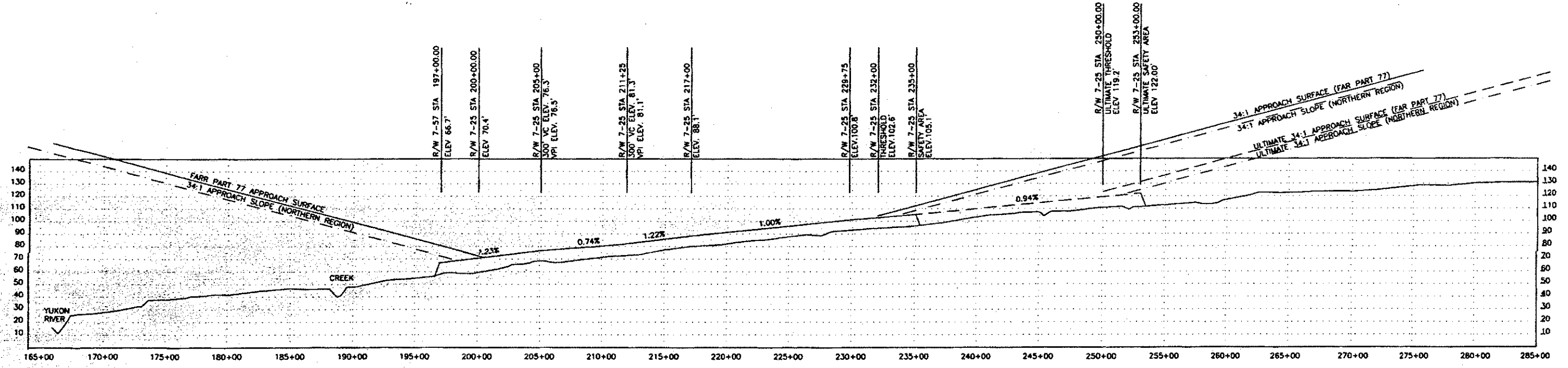

RUNWAY 7-25 PROFILE

DESIGN	ENB
DRAWN	CAT
CHECKED	PDM

BY	DATE	REVISIONS
	8/29/03	FAA APPROVED

STATE OF ALASKA  
 DEPARTMENT OF TRANSPORTATION AND PUBLIC FACILITIES  
 NORTHERN REGION-DESIGN AND CONSTRUCTION-AVIATION

APPROVED  
*Patricia D. Miller* DATE *8/27/03*  
 PATRICIA D. MILLER, P.E. DESIGN GROUP CHIEF

LAYOUT PLAN Conditionally Approved:  
 By *John J. Lovell*  
 AIRPORTS DIVISION, ALASKAN REGION  
 Date 8/29/03

DON HUNTER SR.  
 MARSHALL AIRPORT  
 INNER PORTION OF THE  
 APPROACH SURFACE

SHEET  
 2 OF  
 4

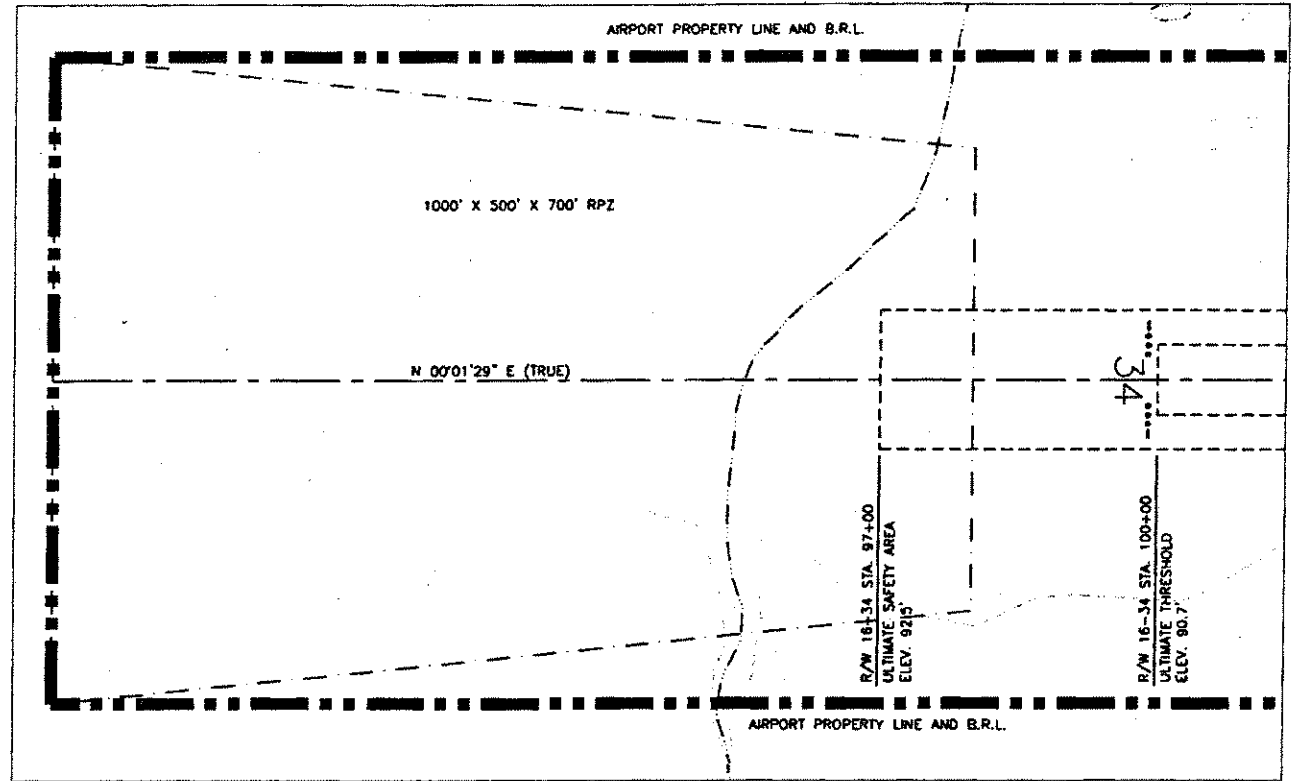

RPZ 34

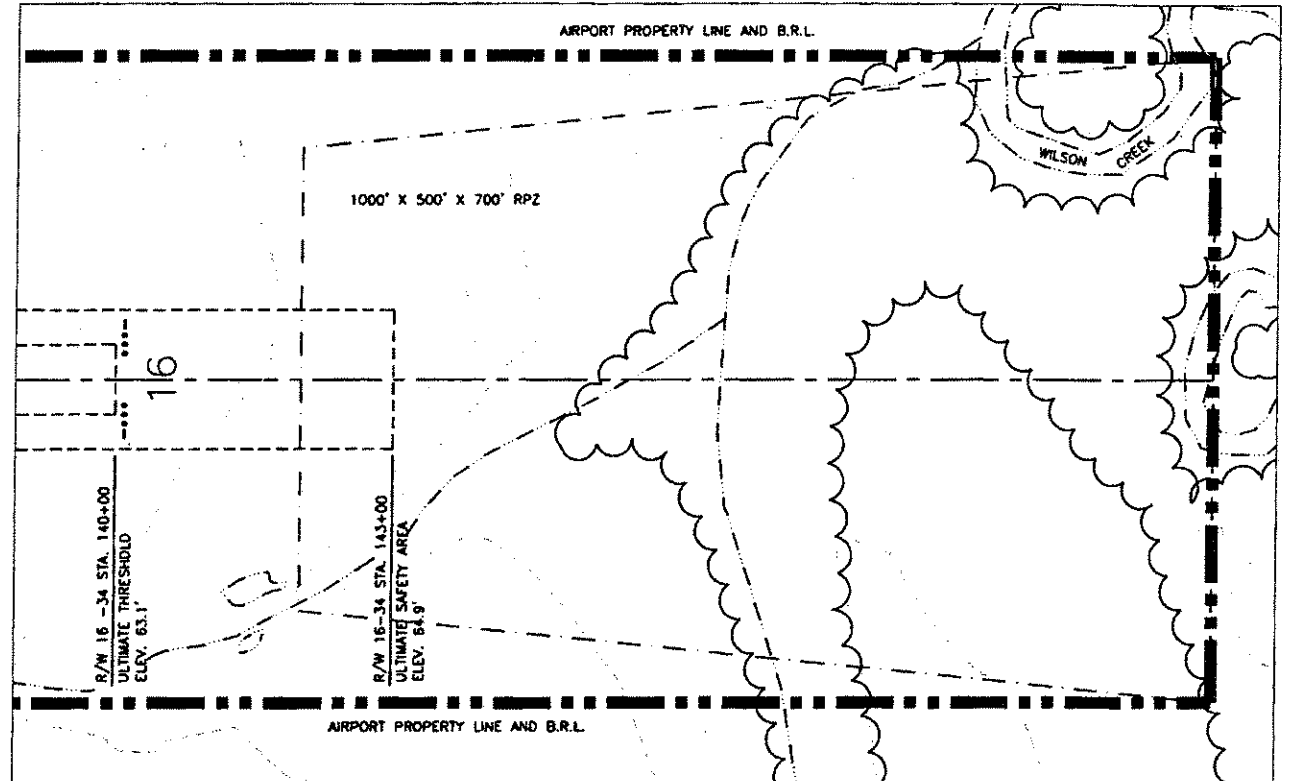

RPZ 16

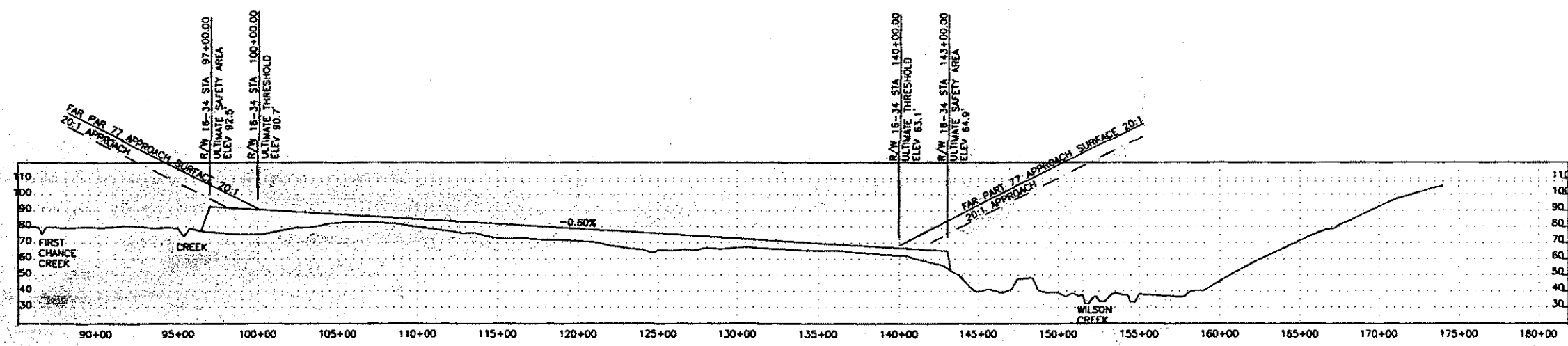

RUNWAY 16-34 PROFILE

DESIGN	ENG
DRAWN	CAT
CHECKED	PDM

BY	DATE	REVISIONS
	8/29/03	FAA APPROVED

STATE OF ALASKA  
 DEPARTMENT OF TRANSPORTATION AND PUBLIC FACILITIES  
 NORTHERN REGION-DESIGN AND CONSTRUCTION-AVIATION

APPROVED  
*Patricia D. Miller* DATE *8/27/03*  
 PATRICIA D. MILLER, P.E. DESIGN GROUP CHIEF

LAYOUT PLAN Conditionally Approved:  
 By *John J. Lovett*  
 AIRPORTS DIVISION, ALASKAN REGION  
 Date 8/29/03

DON HUNTER SR.  
 MARSHALL AIRPORT  
 INNER PORTION OF THE  
 APPROACH SURFACE

SHEET  
 3 OF  
 4

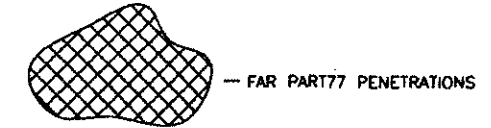
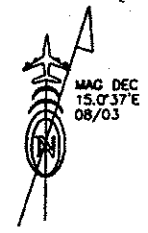
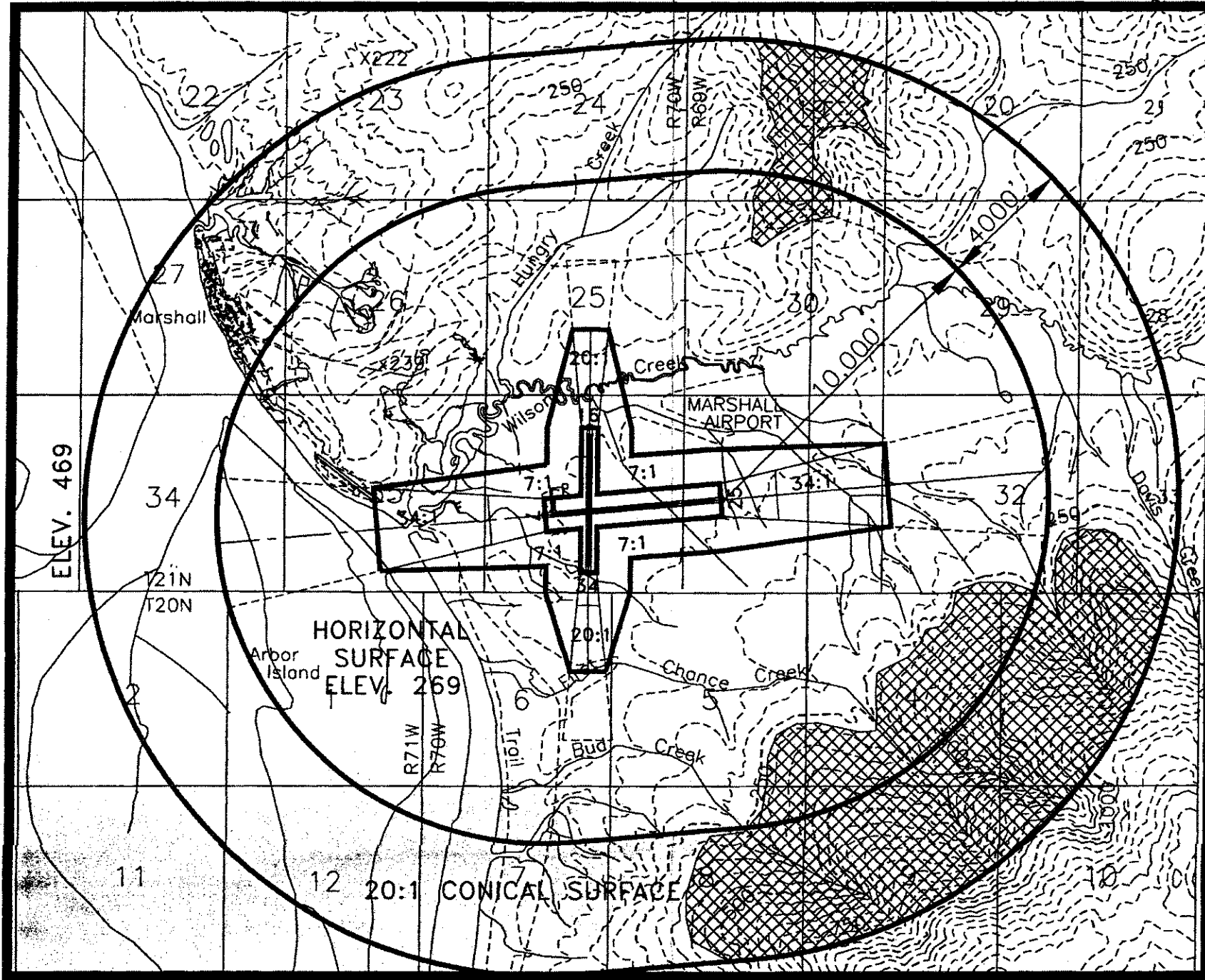

DESIGN	ENR		
DRAWN	CAT		
CHECKED	PDM		
BY	DATE	REVISIONS	
	8/29/03	FAA APPROVED	

STATE OF ALASKA  
 DEPARTMENT OF TRANSPORTATION AND PUBLIC FACILITIES  
 NORTHERN REGION-DESIGN AND CONSTRUCTION-AVIATION

APPROVED  
*Patricia D. Miller* DATE *8/27/03*  
 PATRICIA D. MILLER, P.E. DESIGN GROUP CHIEF

LAYOUT PLAN Conditionally Approved:  
 By *John J. Lovell*  
 AIRPORTS DIVISION, ALASKAN REGION  
 Date 8/29/03

DON HUNTER SR.  
 MARSHALL AIRPORT  
 AIRSPACE

SHEET  
 4 OF  
 4