

**WIND DATA**  
 PILOT REPORTS ARE THE ONLY SOURCE OF WIND DATA AVAILABLE. THE REPORTS INDICATE THAT THE PROPOSED RUNWAY ALIGNMENT HAS GOOD WIND COVERAGE.

**DEVIATIONS FROM DESIGN STANDARDS**

DESCRIPTION	STANDARD	PROPOSED
RUNWAY CENTERLINE TO PARKING APRON (PROPOSED)	225'	50'
RUNWAY SAFETY AREA LENGTH (PROPOSED AND FUTURE)	2,600' MIN.	2,400'

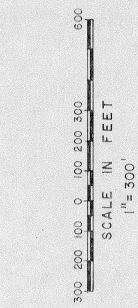
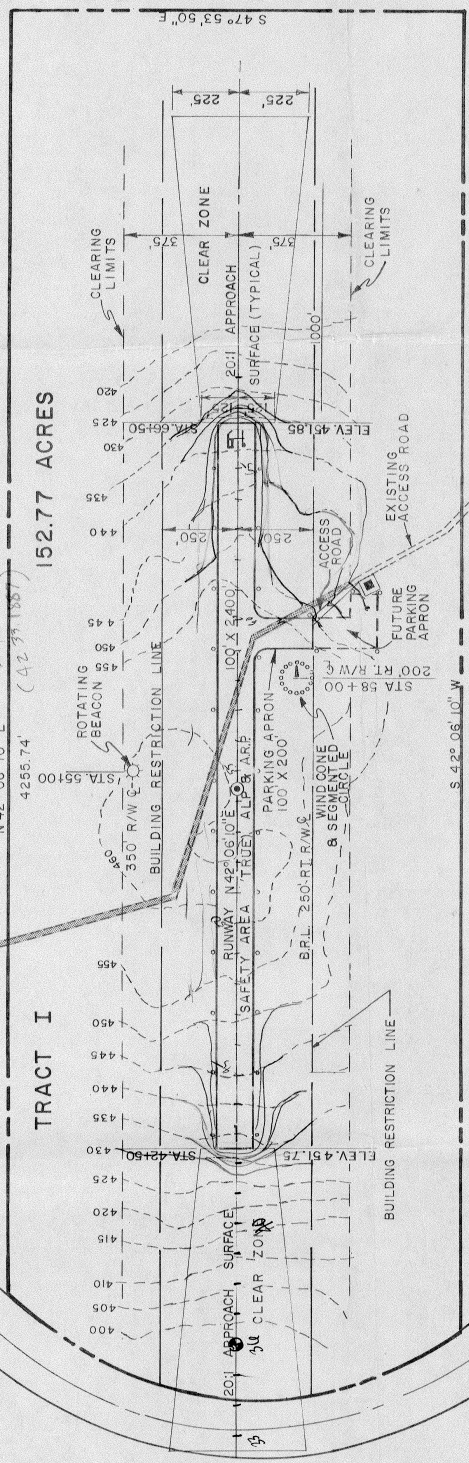

U.S.S. 4469

U.S.C. 4455 D

**BASIC DATA TABLE**

	RUNWAY DATA	
	PROPOSED	FUTURE
EFFECTIVE GRADIENT	0.25	0.25
% WIND COVERAGE	NOT AVAILABLE	N/A
INSTRUMENT RUNWAY	NONE	NONE
TAXIWAY LIGHTING	NONE	7" x 7" F
RAMP LIGHTING	NONE	MED. INT.
RUNWAY SURFACE	GRAVEL	GRAVEL
STRENGTH	12.5 K	12.5 K
APPROACH SURFACES	20.1	20.1
APPROACH LIGHTING	NONE	MED. INT.
RUNWAY MARKINGS	NONE	NONE
OBSTRUCTION LIGHTS	NONE	NONE
SUBGRADE CLASS	E-3 AFS	E-3 AFS
RUNWAY DIMENSIONS	80' X 2400'	80' X 2400'
RUNWAY SAFETY AREA	100' X 2400'	100' X 2400'
* VALUE GIVEN IS TOTAL AIRCRAFT WEIGHT IN 1000 #		
FOR SINGLE (S) WHEEL GEAR AIRCRAFT		

**BASIC DATA TABLE**

AIRPORT DATA	
PROPOSED	FUTURE
AIRPORT ELEVATION (ASSUMED ELEV.)	456.62
NORMAL MAX. TEMP	71° F
TAXIWAY LIGHTING	NONE
RAMP LIGHTING	NONE
AIRPORT REFERENCE POINT (A.R.P.)	LAT 65° 08' 49" N LONG 149° 22' 03" W
CONSTRUCTION	NONE
REFLECTIVE MARKERS	NONE
OFF-AIRPORT BEACON	NONE
SCORE LINE	NONE
EQUIPMENT STORAGE BUILDING	NONE
EQUIPMENT ROAD (TO BE ABANDONED)	NONE
EXISTING ROAD (TO BE MAINTAINED)	NONE

**LEGEND**

PROPOSED	EXISTING
PROPERTY LINE	PROPERTY LINE
BUILDING RESTRICTION LINE (B.R.L.)	BUILDING RESTRICTION LINE (B.R.L.)
CLEARING LIMITS	CLEARING LIMITS
AIRPORT LOCATION POINT (A.L.P.)	AIRPORT LOCATION POINT (A.L.P.)
AIRPORT REFERENCE POINT (A.R.P.)	AIRPORT REFERENCE POINT (A.R.P.)
WIND CONE - 8 SEGMENTED CIRCLE	WIND CONE - 8 SEGMENTED CIRCLE
GROUND CONTOURS (ASSUMED)	GROUND CONTOURS (ASSUMED)
CONSTRUCTION	CONSTRUCTION
REFLECTIVE MARKERS	REFLECTIVE MARKERS
OFF-AIRPORT BEACON	OFF-AIRPORT BEACON
SCORE LINE	SCORE LINE
EQUIPMENT STORAGE BUILDING	EQUIPMENT STORAGE BUILDING
EQUIPMENT ROAD (TO BE ABANDONED)	EQUIPMENT ROAD (TO BE ABANDONED)
EXISTING ROAD (TO BE MAINTAINED)	EXISTING ROAD (TO BE MAINTAINED)

**NOTE:**  
 VERTICAL CONTROL BASED ON ALASKA DEPT OF HIGHWAYS T.B.M. #2, ELEV. 378.66' ELEVATION OF T.B.M. #2 BASED ASSUMED DATUM.

NO.	DATE	REVISIONS
W.K.	11-14-77	REVISED TO 2400' R/W SAFETY AREA
W.K.	1-3-77	REVISED TO 2300' R/W SAFETY AREA
W.K.	7/28/76	F.A.A. APPROVED
P.C.V.	4-27-76	REMOVED RUNWAY LENGTH TO 2000' AND RELOCATED ACCESS ROAD, APRON, AND AIRPORT REFERENCE POINT
P.C.V.	3/3/75	APPROVED BY F.A.A.

STATE OF ALASKA  
 DEPARTMENT OF PUBLIC WORKS  
 DIVISION OF AVIATION  
**NEW MINTO AIRPORT**  
 AIRPORT LAYOUT PLAN

APPROVED: *William J. Hoover, P.E.* CHIEF DESIGN ENGINEER  
*William J. Hoover, P.E.* SECONDARY AIRPORTS ENGINEER

DATE: 11/19/74  
 SHEET: 1 OF 1  
 SCALE: 1" = 300'

*Chg to 1" = 200'*